



# AUSTRALIAN EXHAUST PRODUCT CATALOGUE



## MUFFLER GUIDE

Nelson Global Products, Inc. offers the industry's best solutions for small engine exhaust. Using the latest design and manufacturing techniques, these products provide superior exhaust noise reduction and environmental protection. Original Equipment Manufacturers can count on these products for performance, durability and reliability.



## Duration

|   |        |
|---|--------|
| Diesel Mufflers – Vertical installation     | 1 year |
| Diesel Mufflers – Horizontal installation   | 1 year |
| Marine Exhaust Riser                        | 1 year |
| Gas, Fibreglass packed and Economy Mufflers | 1 year |
| Exhaust accessories                         | 1 year |
| Chrome plated parts                         | 1 year |
| Flex tubing and General Service Items       | None   |



## Warranty

Nelson Global Products Australia exhaust components are warranted for the period nominated in the table above, from the date of sale to the end user under the following conditions:-

- > Nelson Global Products Australia determines the product to be defective in material or workmanship.
- > Warranty is valid for initial installation as an aftermarket replacement by original purchaser.
- > Warranty does not cover the cost of removal, installation or transportation charges.
- > Warranty does not cover failures resulting from faulty installation, misuse, alteration, neglect or accident.
- > Warranty does not cover products that rust or are blown out by backfire, or engine faults.
- > Nelson Global Products Australia is not responsible for downtime, loss of income, living expenses, or incidental or consequential damages.
- > All other warranties, express or implied, of merchantability or fitness for a particular purpose are hereby disclaimed.
- > Muffler is applied only on diesel engine, and only when installed properly on correct engine as described in the current Nelson Global Products Australia catalogues or bulletins.
- > Gas, Fibreglass packed and Economy series mufflers are subject to one year warranty.

## Chrome plated products

Chrome plated products are warranted against peeling and blistering of the chrome plated surface, and against corrosion from beneath the chrome surface for one year.

All warranties for Chrome plated products specifically exclude: -

- > Discolouration due to overheating.
- > Discolouration &/or deterioration of the chrome surface due to the presence of external contaminants such as acidic exhaust gases, iron & coal dust, etc.
- > Rusting or breakdown of chrome plating due to part being cut, altered, welded, or damaged by abrasion or accident.
- > All stacks are hand polished and chrome plated to withstand severe corrosion conditions, thus Cosmetic wrinkles, surface blemishes, etc are not covered as these are considered commercially acceptable.
- > Warranty period begins on final date to end-users.

|   |          |
|---|----------|
| 'Y' junctions   | 26-27    |
| 45°Expanded junction                                    | 6-27     |
| Abbreviations   | 54       |
| Air intake – rubberware / air rams                      | 51       |
| Beaded coupler  | 27       |
| Bends – 30°, 45°, 60°, 90° and 180°                     | 10-13    |
| Clamps  | 18-19    |
| Cones   | 26-27    |
| Donuts  | 26-27    |
| Elbows – rubber   | 48-51    |
| Exhaust stacks – deflector                              | 2-5      |
| Exhaust stacks – mitre cut, silent and super stack      | 8-9      |
| Exhaust stacks – straight and special length            | 6-7      |
| Expanded adaptors and couplers                          | 24-25    |
| Expanded lipped flange                                  | 24-25    |
| Flame proof tanker kits                                 | 30-31    |
| Flex (bellows) connectors, full and pre-cut lengths     | 16-17    |
| Full guard brackets and full guard and half guard wraps | 42-45    |
| Handles   | 44-45    |
| Heat shield   | 42       |
| Hump hose and reducers                                  | 52-53    |
| Lipped flange   | 22-23    |
| Mufflers  | 32-41    |
| Muffler style chart                                     | 32       |
| Pipe shroud kits and accessories                        | 31       |
| Raincaps  | 6        |
| Reducing 90° elbows                                     | 50-51    |
| Reducing noise levels                                   | 35       |
| Shrouds   | 31       |
| Silent raincaps   | 7, 42-43 |
| Single couplers   | 22-23    |
| Spark arrestors   | 46-47    |
| Special elbows – miscellaneous angles                   | 50-51    |
| Splitter tee adaptor pipe                               | 26-27    |
| Stainless steel milk bends                              | 28-29    |
| Straight tube couplers                                  | 22-23    |
| Tanker kit exhaust stacks                               | 31       |
| Tee bolt clamps   | 48-49    |
| Tilt cab connectors and assembly                        | 28-29    |
| Transition caps   | 31       |
| Tube – full & half lengths                              | 15       |
| Tube tolerance levels                                   | 14       |
| V-band clamps   | 20-21    |



# EXHAUST STACKS – DEFLECTOR

## PLAIN END

# EXHAUST STACKS – DEFLECTOR

## PLAIN END

### Available in:

- > MILD STEEL
- > ALUMINISED STEEL
- > CHROME PLATED
- > POLISHED STAINLESS STEEL

Available in two different sizes:

- > 'US' Design (Round shaped outlet).
- > 'AUS' Design (Oval shaped outlet).
- > The use of Chrome plated stacks will enhance the outer appearance of the vehicle.
- > Aluminised stacks are more functional and will provide the owner with an extended period of service.
- > Nelson Global Products Australia uses a nickel-plated, chrome finishing process that meets the Australian Standards (AS1192) Service Condition 4.
- > When replacing a deflector, clamps should be inspected and replaced to ensure that the stack is in a steadfast position at all times.



### Exhaust clamps

- > Our heavy-duty clamps feature some of the latest clamp technology available.
- > All our clamps are designed for fast, easy and accurate installation, while still providing maximum clamping force.
- > Whenever a muffler or exhaust stack on a vehicle is replaced, the clamps used on these parts should also be inspected and replaced to ensure that a leak-free seal is obtained on the exhaust system.



| DIMENSIONAL DATA |              | MILD STEEL | ALUMINISED STEEL | CHROME PLATED | CHROME PLATED 'US STYLE' | ALUMINISED STEEL 'US' |
|------------------|--------------|------------|------------------|---------------|--------------------------|-----------------------|
| 51mm x (2")      | 600mm (24")  | 0121D0522P | ASD0522P         | 0123D0522P    | -                        | -                     |
|                  | 900mm (36")  | 0121D0523P | ASD0523P         | 0123D0523P    | -                        | -                     |
|                  | 1200mm (47") | 0121D0524P | ASD0524P         | 0123D0524P    | -                        | -                     |
|                  | 1500mm (59") | 0121D0525P | ASD0525P         | 0123D0525P    | -                        | -                     |
|                  | 1800mm (71") | 0121D0526P | ASD0526P         | 0123D0526P    | -                        | -                     |
| 57mm x (2 1/4")  | 600mm (24")  | 0121D0572P | ASD0572P         | 0123D0572P    | -                        | -                     |
|                  | 900mm (36")  | 0121D0573P | ASD0573P         | 0123D0573P    | -                        | -                     |
|                  | 1200mm (47") | 0121D0574P | ASD0574P         | 0123D0574P    | -                        | -                     |
|                  | 1500mm (59") | 0121D0575P | ASD0575P         | 0123D0575P    | -                        | -                     |
|                  | 1800mm (71") | 0121D0576P | ASD0576P         | 0123D0576P    | -                        | -                     |
| 63mm x (2 1/2")  | 600mm (24")  | 0121D0632P | ASD0632P         | 0123D0632P    | -                        | -                     |
|                  | 900mm (36")  | 0121D0633P | ASD0633P         | 0123D0633P    | -                        | -                     |
|                  | 1200mm (47") | 0121D0634P | ASD0634P         | 0123D0634P    | -                        | -                     |
|                  | 1500mm (59") | 0121D0635P | ASD0635P         | 0123D0635P    | -                        | -                     |
|                  | 1800mm (71") | 0121D0636P | ASD0636P         | 0123D0636P    | -                        | -                     |
| 70mm x (2 3/4")  | 600mm (24")  | 0121D0702P | -                | 0123D0702P    | -                        | -                     |
|                  | 900mm (36")  | 0121D0703P | -                | 0123D0703P    | -                        | -                     |
|                  | 1200mm (47") | 0121D0704P | -                | 0123D0704P    | -                        | -                     |
|                  | 1500mm (59") | 0121D0705P | -                | 0123D0705P    | -                        | -                     |
|                  | 1800mm (71") | 0121D0706P | -                | 0123D0706P    | -                        | -                     |
| 76mm x (3")      | 600mm (24")  | 0121D0762P | ASD0762P         | 0123D0762P    | -                        | -                     |
|                  | 900mm (36")  | 0121D0763P | ASD0763P         | 0123D0763P    | -                        | -                     |
|                  | 1200mm (47") | 0121D0764P | ASD0764P         | 0123D0764P    | -                        | -                     |
|                  | 1500mm (59") | 0121D0765P | ASD0765P         | 0123D0765P    | -                        | -                     |
|                  | 1800mm (71") | 0121D0766P | ASD0766P         | 0123D0766P    | -                        | -                     |
| 89mm x (3 1/2")  | 600mm (24")  | 0121D0892P | ASD0892P         | 0123D0892P    | -                        | -                     |
|                  | 900mm (36")  | 0121D0893P | ASD0893P         | 0123D0893P    | -                        | -                     |
|                  | 1200mm (47") | 0121D0894P | ASD0894P         | 0123D0894P    | -                        | -                     |
|                  | 1500mm (59") | 0121D0895P | ASD0895P         | 0123D0895P    | -                        | -                     |
|                  | 1800mm (71") | 0121D0896P | ASD0896P         | 0123D0896P    | -                        | -                     |
| 102mm x (4")     | 600mm (24")  | 0121D1022P | ASD1022P         | 0123D1022P    | -                        | -                     |
|                  | 900mm (36")  | 0121D1023P | ASD1023P         | 0123D1023P    | 89044C                   | -                     |
|                  | 1200mm (47") | 0121D1024P | ASD1024P         | 0123D1024P    | 89045C                   | -                     |
|                  | 1500mm (59") | 0121D1025P | ASD1025P         | 0123D1025P    | -                        | -                     |
|                  | 1800mm (71") | 0121D1026P | ASD1026P         | 0123D1026P    | -                        | -                     |
| 114mm x (4 1/2") | 600mm (24")  | 0121D1142P | ASD1142P         | 0123D1142P    | -                        | -                     |
|                  | 900mm (36")  | 0121D1143P | ASD1143P         | 0123D1143P    | -                        | -                     |
|                  | 1200mm (47") | 0121D1144P | ASD1144P         | 0123D1144P    | -                        | -                     |
|                  | 1500mm (59") | 0121D1145P | ASD1145P         | 0123D1145P    | -                        | -                     |
|                  | 1800mm (71") | 0121D1146P | ASD1146P         | 0123D1146P    | -                        | -                     |
| 127mm x (5")     | 600mm (24")  | 0121D1272P | ASD1272P         | 0123D1272P    | 89046C                   | -                     |
|                  | 900mm (36")  | 0121D1273P | ASD1273P         | 0123D1273P    | 89047C                   | -                     |
|                  | 1200mm (47") | 0121D1274P | ASD1274P         | 0123D1274P    | -                        | -                     |
|                  | 1500mm (59") | 0121D1275P | ASD1275P         | 0123D1275P    | -                        | -                     |
|                  | 1800mm (71") | 0121D1276P | ASD1276P         | 0123D1276P    | 89296C                   | -                     |
| 152mm x (6")     | 600mm (24")  | 0121D1522P | ASD1522P         | 0123D1522P    | -                        | -                     |
|                  | 900mm (36")  | 0121D1523P | ASD1523P         | 0123D1523P    | -                        | -                     |
|                  | 1200mm (47") | 0121D1524P | ASD1524P         | 0123D1524P    | -                        | -                     |
|                  | 1500mm (59") | 0121D1525P | ASD1525P         | 0123D1525P    | -                        | -                     |
|                  | 1800mm (71") | 0121D1526P | ASD1526P         | 0123D1526P    | -                        | -                     |

# EXHAUST STACKS – DEFLECTOR

## EXPANDED AND NOTCHED

# EXHAUST STACKS – DEFLECTOR

## EXPANDED AND NOTCHED

### Available in:

- > **MILD STEEL**
- > **ALUMINISED STEEL**
- > **CHROME PLATED**
- > **POLISHED STAINLESS STEEL**

Available in two different sizes:

- > 'US' Design (Round shaped outlet).
- > 'AUS' Design (Oval shaped outlet).
- > The use of Chrome plated stacks will enhance the outer appearance of the vehicle.
- > Aluminised stacks are more functional and will provide the owner with an extended period of service.
- > Nelson Global Products Australia uses a nickel-plated, chrome finishing process that meets the Australian Standards (AS1192) Service Condition 4.
- > When replacing a deflector, clamps should be inspected and replaced to ensure that the stack is in a steadfast position at all times.



### Exhaust clamps

- > Our heavy-duty clamps feature some of the latest clamp technology available.
- > All our clamps are designed for fast, easy and accurate installation, while still providing maximum clamping force.
- > Whenever a muffler or exhaust stack on a vehicle is replaced, the clamps used on these parts should also be inspected and replaced to ensure that a leak-free seal is obtained on the exhaust system.



| DIMENSIONAL DATA |              | MILD STEEL | ALUMINISED STEEL | CHROME PLATED | CHROME PLATED METRIC STACK | CHROME PLATED 'US STYLE' | ALUMINISED STEEL 'US' |
|------------------|--------------|------------|------------------|---------------|----------------------------|--------------------------|-----------------------|
| 51mm x (2")      | 600mm (24")  | 0121D0522X | ASD0522X         | 0123D0522X    | -                          | -                        | -                     |
|                  | 900mm (36")  | 0121D0523X | ASD0523X         | 0123D0523X    | -                          | -                        | -                     |
|                  | 1200mm (47") | 0121D0524X | ASD0524X         | 0123D0524X    | -                          | -                        | -                     |
|                  | 1500mm (59") | 0121D0525X | ASD0525X         | 0123D0525X    | -                          | -                        | -                     |
|                  | 1800mm (71") | 0121D0526X | ASD0526X         | 0123D0526X    | -                          | -                        | -                     |
| 57mm x (2 1/4")  | 600mm (24")  | 0121D0572X | ASD0572X         | 0123D0572X    | -                          | -                        | -                     |
|                  | 900mm (36")  | 0121D0573X | ASD0573X         | 0123D0573X    | -                          | -                        | -                     |
|                  | 1200mm (47") | 0121D0574X | ASD0574X         | 0123D0574X    | -                          | -                        | -                     |
|                  | 1500mm (59") | 0121D0575X | ASD0575X         | 0123D0575X    | -                          | -                        | -                     |
|                  | 1800mm (71") | 0121D0576X | ASD0576X         | 0123D0576X    | -                          | -                        | -                     |
| 63mm x (2 1/2")  | 600mm (24")  | 0121D0632X | ASD0632X         | 0123D0632X    | -                          | -                        | -                     |
|                  | 900mm (36")  | 0121D0633X | ASD0633X         | 0123D0633X    | -                          | -                        | -                     |
|                  | 1200mm (47") | 0121D0634X | ASD0634X         | 0123D0634X    | -                          | -                        | -                     |
|                  | 1500mm (59") | 0121D0635X | ASD0635X         | 0123D0635X    | -                          | -                        | -                     |
|                  | 1800mm (71") | 0121D0636X | ASD0636X         | 0123D0636X    | -                          | -                        | -                     |
| 70mm x (2 3/4")  | 600mm (24")  | 0121D0702X | -                | 0123D0702X    | -                          | -                        | -                     |
|                  | 900mm (36")  | 0121D0703X | -                | 0123D0703X    | -                          | -                        | -                     |
|                  | 1200mm (47") | 0121D0704X | -                | 0123D0704X    | -                          | -                        | -                     |
|                  | 1500mm (59") | 0121D0705X | -                | 0123D0705X    | -                          | -                        | -                     |
|                  | 1800mm (71") | 0121D0706X | -                | 0123D0706X    | -                          | -                        | -                     |
| 76mm x (3")      | 600mm (24")  | 0121D0762X | ASD0762X         | 0123D0762X    | 0123D0762HX                | -                        | -                     |
|                  | 900mm (36")  | 0121D0763X | ASD0763X         | 0123D0763X    | 0123D0763HX                | -                        | -                     |
|                  | 1200mm (47") | 0121D0764X | ASD0764X         | 0123D0764X    | 0123D0764HX                | -                        | -                     |
|                  | 1500mm (59") | 0121D0765X | ASD0765X         | 0123D0765X    | 0123D0765HX                | -                        | 925051A               |
|                  | 1800mm (71") | 0121D0766X | ASD0766X         | 0123D0766X    | 0123D0766HX                | -                        | -                     |
| 89mm x (3 1/2")  | 600mm (24")  | 0121D0892X | ASD0892X         | 0123D0892X    | 0123D0892HX                | -                        | -                     |
|                  | 900mm (36")  | 0121D0893X | ASD0893X         | 0123D0893X    | 0123D0893HX                | -                        | -                     |
|                  | 1200mm (47") | 0121D0894X | ASD0894X         | 0123D0894X    | 0123D0894HX                | -                        | -                     |
|                  | 1500mm (59") | 0121D0895X | ASD0895X         | 0123D0895X    | 0123D0895HX                | -                        | -                     |
|                  | 1800mm (71") | 0121D0896X | ASD0896X         | 0123D0896X    | 0123D0896HX                | -                        | -                     |
| 102mm x (4")     | 600mm (24")  | 0121D1022X | ASD1022X         | 0123D1022X    | -                          | 89055C                   | -                     |
|                  | 900mm (36")  | 0121D1023X | ASD1023X         | 0123D1023X    | -                          | 89056C                   | -                     |
|                  | 1200mm (47") | 0121D1024X | ASD1024X         | 0123D1024X    | -                          | -                        | -                     |
|                  | 1500mm (59") | 0121D1025X | ASD1025X         | 0123D1025X    | -                          | -                        | -                     |
|                  | 1800mm (71") | 0121D1026X | ASD1026X         | 0123D1026X    | -                          | -                        | -                     |
| 114mm x (4 1/2") | 600mm (24")  | 0121D1142X | ASD1142X         | 0123D1142X    | -                          | -                        | -                     |
|                  | 900mm (36")  | 0121D1143X | ASD1143X         | 0123D1143X    | -                          | -                        | -                     |
|                  | 1200mm (47") | 0121D1144X | ASD1144X         | 0123D1144X    | -                          | -                        | -                     |
|                  | 1500mm (59") | 0121D1145X | ASD1145X         | 0123D1145X    | -                          | -                        | -                     |
|                  | 1800mm (71") | 0121D1146X | ASD1146X         | 0123D1146X    | -                          | -                        | -                     |
| 127mm x (5")     | 600mm (24")  | 0121D1272X | ASD1272X         | 0123D1272X    | -                          | -                        | -                     |
|                  | 900mm (36")  | 0121D1273X | ASD1273X         | 0123D1273X    | -                          | -                        | -                     |
|                  | 1200mm (47") | 0121D1274X | ASD1274X         | 0123D1274X    | -                          | -                        | -                     |
|                  | 1500mm (59") | 0121D1275X | ASD1275X         | 0123D1275X    | -                          | 89227C                   | -                     |
|                  | 1800mm (71") | 0121D1276X | ASD1276X         | 0123D1276X    | -                          | -                        | -                     |
| 152mm x (6")     | 600mm (24")  | 0121D1522X | ASD1522X         | 0123D1522X    | -                          | -                        | -                     |
|                  | 900mm (36")  | 0121D1523X | ASD1523X         | 0123D1523X    | -                          | -                        | -                     |
|                  | 1200mm (47") | 0121D1524X | ASD1524X         | 0123D1524X    | -                          | -                        | -                     |
|                  | 1500mm (59") | 0121D1525X | ASD1525X         | 0123D1525X    | -                          | -                        | -                     |
|                  | 1800mm (71") | 0121D1526X | ASD1526X         | 0123D1526X    | -                          | -                        | -                     |



# EXHAUST STACKS

## STRAIGHT

### Straight

- Available as a Plain End or Expanded and Notched.
- Straight stacks give the impression of a quieter vehicle as the noise is directed away from the ground.
- Requires a raincap to prevent rain from entering the exhaust system which if not fitted, will eventually result in rust being formed in the muffler.
- Also available in Aluminised material against special order. Minimum order quantities may apply.



### Raincaps

- When using a straight stack, remember your raincap.
- Nelson Global Products Australia is proud to offer a selection of ZINC or CHROME PLATED genuine 'Mercury' manufactured raincaps.
- The primary function of any raincap is to protect the muffler and exhaust system from rust and carbon residue.
- Our raincaps feature a single bolt mounting design and have been heavy duty welded for a longer service life.
- These raincaps are precision balanced and include nylon stops for a 'SILENT' operation.
- Raincaps can be ordered in single units or bulk packs. Bulk packs are available at a discounted rate.



Note: If ordering in bulk quantities, please add -B to the end of the part number. eg: 0171038ES-B

# EXHAUST STACKS

## STRAIGHT AND SPECIAL LENGTH

| EXHAUST STACKS – CHROME PLATED (STRAIGHT) |              |            |                    |
|---|--------------|------------|--------------------|
| DIMENSIONAL DATA                          |              | PLAIN END  | EXPANDED & NOTCHED |
| 51mm x (2")                               | 600mm (24")  | 0123S0522P | 0123S0522X         |
|   | 900mm (36")  | 0123S0523P | 0123S0523X         |
|   | 1200mm (47") | 0123S0524P | 0123S0524X         |
|   | 1500mm (59") | 0123S0525P | 0123S0525X         |
|   | 1800mm (71") | 0123S0526P | 0123S0526X         |
| 57mm x (2 1/4")                           | 600mm (24")  | 0123S0572P | 0123S0572X         |
|   | 900mm (36")  | 0123S0573P | 0123S0573X         |
|   | 1200mm (47") | 0123S0574P | 0123S0574X         |
|   | 1500mm (59") | 0123S0575P | 0123S0575X         |
|   | 1800mm (71") | 0123S0576P | 0123S0576X         |
| 63mm x (2 1/2")                           | 600mm (24")  | 0123S0632P | 0123S0632X         |
|   | 900mm (36")  | 0123S0633P | 0123S0633X         |
|   | 1200mm (47") | 0123S0634P | 0123S0634X         |
|   | 1500mm (59") | 0123S0635P | 0123S0635X         |
|   | 1800mm (71") | 0123S0636P | 0123S0636X         |
| 70mm x (2 3/4")                           | 600mm (24")  | 0123S0702P | 0123S0702X         |
|   | 900mm (36")  | 0123S0703P | 0123S0703X         |
|   | 1200mm (47") | 0123S0704P | 0123S0704X         |
|   | 1500mm (59") | 0123S0705P | 0123S0705X         |
|   | 1800mm (71") | 0123S0706P | 0123S0706X         |
| 76mm x (3")                               | 600mm (24")  | 89005C     | 0123S0762X         |
|   | 900mm (36")  | 89006C     | 89020C             |
|   | 1200mm (47") | 89007C     | 89021C             |
|   | 1500mm (59") | 89203C     |                    |
|   | 1800mm (71") | 0123S0766P | 0123S0766X         |
| 89mm x (3 1/2")                           | 600mm (24")  | 89010C     | 89022C             |
|   | 900mm (36")  | 89011C     | 89023C             |
|   | 1200mm (47") | 89012C     | 89024C             |
|   | 1500mm (59") | 89204C     | 89215C             |
|   | 1800mm (71") | 0123S0896P | 0123S0896X         |
| 102mm x (4")                              | 600mm (24")  | 89013C     | 89025C             |
|   | 900mm (36")  | 89014C     | 89026C             |
|   | 1200mm (47") | 89015C     | 89027C             |
|   | 1500mm (59") | 89205C     | 89217C             |
|   | 1800mm (71") | 89916C     | 89919C             |
| 114mm x (4 1/2")                          | 600mm (24")  | 0123S1142P | 0123S1142X         |
|   | 900mm (36")  | 0123S1143P | 0123S1143X         |
|   | 1200mm (47") | 0123S1144P | 0123S1144X         |
|   | 1500mm (59") | 0123S1145P | 0123S1145X         |
|   | 1800mm (71") | 0123S1146P | 0123S1146X         |
| 127mm x (5")                              | 600mm (24")  | 89016C     | 89028C             |
|   | 900mm (36")  | 89017C     | 89029C             |
|   | 1200mm (47") | 89018C     | 89030C             |
|   | 1500mm (59") | 89019C     | 89031C             |
|   | 1800mm (71") | 89918C     | 89920C             |
| 152mm x (6")                              | 600mm (24")  | 0123S1522P | 0123S1522X         |
|   | 900mm (36")  | 0123S1523P | 0123S1523X         |
|   | 1200mm (47") | 0123S1524P | 0123S1524X         |
|   | 1500mm (59") | 0123S1525P | 0123S1525X         |
|   | 1800mm (71") | 0123S1526P | 0123S1526X         |

### SILENT RAINCAPS GENUINE 'MERCURY' MANUFACTURE

| ZINC PLATED |                |         |        |
|-------------|----------------|---------|--------|
| PART NUMBER | BULK PACK QTY+ | SUIT OD |        |
| 0171038ES   | 60             | 38mm    | 1 1/2" |
| 0171044ES   | 55             | 44mm    | 1 3/4" |
| 0171051ES   | 40             | 51mm    | 2"     |
| 0171057ES   | 35             | 57mm    | 2 1/4" |
| 0171063ES   | 30             | 63mm    | 2 1/2" |
| 0171070ES   | 25             | 70mm    | 2 3/4" |
| 0171076ES   | 25             | 76mm    | 3"     |
| 0171089ES   | 35             | 89mm    | 3 1/2" |
| 0171102ES   | 25             | 102mm   | 4"     |
| 0171114ES   | 20             | 114mm   | 4 1/2" |
| 0171127ES   | 20             | 127mm   | 5"     |
| 0171140ES   | -              | 140mm   | 5 1/2" |
| 0171152ES   | 15             | 152mm   | 6"     |
| 0171203ES   | -              | 203mm   | 8"     |

> For bulk packs, please add -B to the end of the part number.

| CHROME PLATED |               |         |        |
|---------------|---------------|---------|--------|
| PART NUMBER   | BULK PACK QTY | SUIT OD |        |
| 0171038ESC    | -             | 38mm    | 1 1/2" |
| 0171044ESC    | -             | 44mm    | 1 3/4" |
| 0171051ESC    | -             | 51mm    | 2"     |
| 0171057ESC    | -             | 57mm    | 2 1/4" |
| 0171063ESC    | -             | 63mm    | 2 1/2" |
| 0171070ESC    | -             | 70mm    | 2 3/4" |
| 0171076ESC    | 25            | 76mm    | 3"     |
| 0171089ESC    | -             | 89mm    | 3 1/2" |
| 0171102ESC    | 25            | 102mm   | 4"     |
| 0171114ESC    | -             | 114mm   | 4 1/2" |
| 0171127ESC    | 20            | 127mm   | 5"     |
| 0171140ESC    | -             | 140mm   | 5 1/2" |
| 0171152ESC    | 15            | 152mm   | 6"     |

# EXHAUST STACKS

## SILENT, SUPER AND MITRE CUT

### Silent stacks

#### Available in:

- > ALUMINISED STEEL
- > POLISHED STAINLESS STEEL

- > Can reduce exhaust noise by 3 to 4 dBA.
- > Mounts directly into existing system replacing the conventional stack.
- > Available as a Straight Stack or Deflector Pipe.



### Super stacks - reduced inlet

#### Available in:

- > 'US' Design
- > 'AUS' Design

- > Can reduce exhaust noise by 3 to 4 dBA.
- > Mounts directly into existing system replacing the conventional stack.
- > Available as a Straight Stack or Deflector Pipe.



### Mitre cut stacks

- > Mitre Cut stacks gives the impression of a quieter vehicle as the noise is directed away from the ground.
- > These stacks have a angle cut of 45° at the top of the stack.
- > Also known as West Coast and Angle Cut stacks.
- > Also available in Aluminised material against special order. Minimum order quantities may apply.
- > 178mm (7") stacks available on request either as straight inlet or reduced to 127mm (plain or notched).
- > 178mm (7") stacks available on request either as straight inlet or reduced to 152mm (plain or notched).



# EXHAUST STACKS

## SILENT, SUPER AND MITRE CUT

| SILENT STACKS    |                             |                  |                 |                          |
|------------------|-----------------------------|------------------|-----------------|--------------------------|
| DIMENSIONAL DATA |                             | ALUMINISED STEEL | STAINLESS STEEL | POLISHED STAINLESS STEEL |
| 102mm x (4")     | 900mm (36")<br>1143mm (45") | -                | -               | -                        |
| 127mm x (5")     | 900mm (36")<br>1143mm (45") | 89194U           | -               | 89192U                   |

| CHROME PLATED SUPER STACKS – REDUCED INLET |                      |             |                       |             |                      |         |         |
|--|----------------------|-------------|-----------------------|-------------|----------------------|---------|---------|
| DIMENSIONAL DATA                           | 'AUS' STYLE STRAIGHT |             | 'AUS' STYLE DEFLECTOR |             | 'US' STYLE DEFLECTOR |         |         |
|  | PLAIN                | NOTCHED     | PLAIN                 | NOTCHED     | PLAIN                | NOTCHED |         |
| 127(102) x (5(4"))                         | 900mm (36")          | 0123S1273RP | 0123S1273RX           | 0123D1273RP | 0123D1273RX          | -       | -       |
|  | 1200mm (47")         | 0123S1274RP | 0123S1274RX           | 0123D1274RP | 0123D1274RX          | -       | -       |
|  | 1500mm (59")         | 0123S1275RP | 0123S1275RX           | 0123D1275RP | 0123D1275RX          | -       | -       |
|  | 1800mm (71")         | 0123S1276RP | 0123S1276RX           | 0123D1276RP | 0123D1276RX          | -       | -       |
| 152(127) x (6(5"))                         | 900mm (36")          | 0123S1523RP | 0123S1523RX           | 0123D1523RP | 0123D1523RX          | -       | -       |
|  | 915mm (36")          | -           | -                     | -           | -                    | -       | -       |
|  | 1200mm (47")         | 0123S1524RP | 0123S1524RX           | 0123D1524RP | 0123D1524RX          | -       | -       |
|  | 1219mm (48")         | -           | -                     | -           | -                    | -       | 924072C |
|  | 1500mm (59")         | 0123S1525RP | 0123S1525RX           | 0123D1525RP | 0123D1525RX          | -       | -       |
|  | 1524mm (60")         | -           | -                     | -           | -                    | -       | -       |
|  | 1800mm (71")         | 0123S1526RP | 0123S1526RX           | 0123D1526RP | 0123D1526RX          | -       | -       |
|  | 1829mm (72")         | -           | -                     | -           | -                    | -       | -       |
|  | 2134mm (84")         | -           | -                     | -           | -                    | -       | -       |
|  | 2438mm (96")         | -           | -                     | -           | -                    | -       | -       |
| 178(127) x (7(5"))                         | 900mm (36")          | 0123S1783RP | -                     | 0123D1783RP | -                    | -       | -       |
|  | 1200mm (48")         | 0123S1784RP | -                     | 0123D1784RP | -                    | -       | -       |
|  | 1500mm (59")         | 0123S1785RP | -                     | 0123D1785RP | -                    | -       | -       |
|  | 1800mm (71")         | 0123S1786RP | -                     | -           | -                    | -       | -       |

| CHROME PLATED 45° MITRE CUT STACKS |               |           |                  |               |         |            |            |
|------------------------------------|---------------|-----------|------------------|---------------|---------|------------|------------|
| STRAIGHT INLET                     |               |           |                  | REDUCED INLET |         |            |            |
| TUBE OD X LENGTH                   | PLAIN END     | NOTCHED   | TUBE OD X LENGTH | PLAIN END     | NOTCHED |            |            |
| 102 x (4")                         | 457mm (18")   | 89906C    | 89906C           | 127(102) x    | 900mm   | CPMS1273RP | CPMS1273RX |
|                                    | 900mm (36")   | 89991C    | 90593C           |               | 1200mm  | CPMS1274RP | CPMS1274RX |
|                                    | 1200mm (47")  | 89992C    | 90595C           |               | 1500mm  | CPMS1275RP | CPMS1275RX |
|                                    | 1500mm (59")  | CPMS1025P | CPMS1025X        |               | 1800mm  | CPMS1276RP | CPMS1276RX |
|                                    | 1800mm (71")  | CPMS1026P | CPMS1026X        |               |         |            |            |
| 127 x (5")                         | 457mm (18")   | -         | -                | 152(127) x    | 900mm   | 900092C    | CPMS1523RX |
|                                    | 900mm (36")   | 89993C    | CPMS1273X        |               | 1200mm  | 900093C    | 900035C    |
|                                    | 1200mm (47")  | 89994C    | CPMS1274X        |               | 1500mm  | 900094C    | CPMS1525RX |
|                                    | 1500mm (59")  | 90438C    | 90439C           |               | 1800mm  | CPMS1526RP | CPMS1526RX |
|                                    | 1800mm (71")  | 90589C    | 90440C           |               | 2438mm  | -          | -          |
|                                    | 2134mm (84")  | -         | 90441C           |               | 3048mm  | -          | -          |
|                                    | 2438mm (96")  | -         | -                |               | 2743mm  | -          | -          |
|                                    | 2743mm (108") | -         | -                |               |         |            |            |
| 152 x (6")                         | 900mm (36")   | CPMS1523P | CPMS1523X        | 178(127) x    | 900mm   | CPMS1783RP | -          |
|                                    | 1200mm (47")  | CPMS1524P | CPMS1524X        |               | 1200mm  | CPMS1784RP | -          |
|                                    | 1500mm (59")  | CPMS1525P | CPMS1525X        |               | 1500mm  | CPMS1785RP | -          |
|                                    | 1800mm (71")  | CPMS1526P | CPMS1526X        |               | 1800mm  | CPMS1786RP | -          |
| 178 x (7")                         | 900mm (36")   | CPMS1783P | -                |               |         |            |            |
|                                    | 1200mm (47")  | CPMS1784P | -                |               |         |            |            |
|                                    | 1500mm (59")  | CPMS1785P | -                |               |         |            |            |
|                                    | 1800mm (71")  | CPMS1786P | -                |               |         |            |            |



# BENDS

30° / 45° / 60°

## Bends - 30° standard

### Available in:

- > STAINLESS STEEL
- > MILD STEEL
- > CHROME PLATED
- > ALUMINISED STEEL (16 Gauge)
- > Also available expanded and notched.

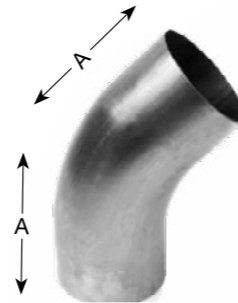

## Bends - 45° standard

### Available in:

- > STAINLESS STEEL
- > MILD STEEL
- > CHROME PLATED
- > ALUMINISED STEEL (16 Gauge)
- > Also available expanded and notched.
- > CLR = 1.5 x diameter.



## Bends - 45° standard

### Available in:

- > MILD STEEL
- > ALUMINISED STEEL (16 Gauge)
- > Also available expanded and notched.

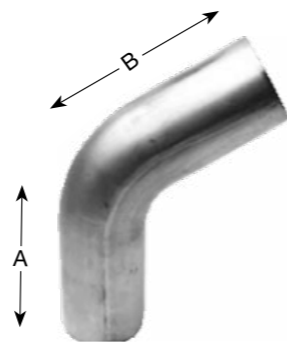

## Bends - 60° standard

### Available in:

- > STAINLESS STEEL
- > MILD STEEL
- > CHROME PLATED
- > ALUMINISED STEEL (16 Gauge)
- > Also available expanded and notched.
- > CLR = 1.5 x diameter.

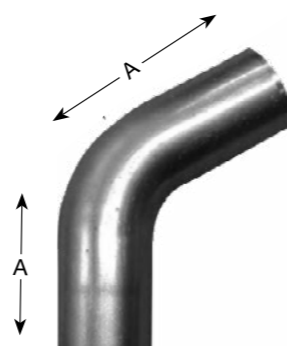

# BENDS

30° / 45° / 60°

## BENDS – 30° STANDARD

| OD x OD |        | CLR   |     | ALUMINISED STEEL | LEG LENGTH A |
|---------|--------|-------|-----|------------------|--------------|
| 89mm    | 3 1/2" | 127mm | 5"  | 900076A          | 102mm (4")   |
| 102mm   | 4"     | 127mm | 5"  | 900077A          | 102mm (4")   |
| 127mm   | 5"     | 152mm | 6"  | 900078A          | 102mm (4")   |
| 152mm   | 6"     | 254mm | 10" | 900079A          | 229mm (9")   |

- > Other tube sizes available for bending.
- > Mild Steel also available in 30° bends.

## BENDS – 45° STANDARD

| OD    |        | CLR   |         | MILD STEEL | ALUMINISED STEEL | STAINLESS STEEL |            |
|-------|--------|-------|---------|------------|------------------|-----------------|------------|
|       |        |       |         |            |                  | TYPE 304        | TYPE 316   |
| 25mm  | 1"     | 38mm  | 1 1/2"  | 010102545  | -                | 050102645H      | 050102545J |
| 29mm  | 1 1/8" | 44mm  | 1 3/4"  | 010102945  | -                | -               | -          |
| 32mm  | 1 1/4" | 48mm  | 1 7/8"  | 010103245  | -                | 050103245H      | 050103245J |
| 35mm  | 1 3/8" | 76mm  | 3"      | 010103545  | -                | -               | -          |
| 38mm  | 1 1/2" | 57mm  | 2 1/4"  | 010103845  | 010103845A       | 050103845H      | 050103845J |
| 41mm  | 1 5/8" | 76mm  | 3"      | 010104145  | 010104145A       | -               | -          |
| 44mm  | 1 3/4" | 66mm  | 2 3/5"  | 010104445  | 010104445A       | 050104445H      | 050104445J |
| 48mm  | 1 7/8" | 72mm  | 2 4/5"  | 010104845  | 010104845A       | -               | -          |
| 51mm  | 2"     | 76mm  | 3"      | 010105145  | 010105145A       | 050105145H      | 050105145J |
| 57mm  | 2 1/4" | 86mm  | 3 2/5"  | 010105745  | 010105745A       | -               | -          |
| 63mm  | 2 1/2" | 95mm  | 3 3/4"  | 010106345  | 010106345A       | 050106345H      | 050106345J |
| 70mm  | 2 3/4" | 105mm | 4 1/10" | 010107045  | -                | -               | -          |
| 76mm  | 3"     | 114mm | 4 1/2"  | 010107645  | 010107645A       | 050107645H      | 050107645J |
| 89mm  | 3 1/2" | 134mm | 5 1/4"  | 010108945  | 010108945A       | 050108945H      | 050108945J |
| 102mm | 4"     | 152mm | 6"      | 010110245  | 010110245A       | 050110145H      | 050110145J |
| 114mm | 4 1/2" | 171mm | 6 3/4"  | 010111445  | 010111445A       | -               | -          |
| 127mm | 5"     | 203mm | 8"      | 010112745  | 010112745A       | 050112745H      | 050112745J |
| 152mm | 6"     | 229mm | 9"      | 010115245  | 010115245A       | 050115245H      | 050115245J |

## BENDS – 45° STANDARD LONG LEG

| OD    | CLR    | MILD STEEL   | ALUMINISED STEEL | LEG LENGTH |             |
|-------|--------|--------------|------------------|------------|-------------|
|       |        |              |                  | A          | B           |
| 63mm  | 2 1/2" | 95mm 3 3/4"  | 010306345        | 010306345A | 300mm 600mm |
| 76mm  | 3"     | 114mm 4 1/2" | 010307645        | 010307645A | 295mm 550mm |
| 89mm  | 3 1/2" | 134mm 5 1/4" | 010308945        | 010308945A | 300mm 550mm |
| 102mm | 4"     | 152mm 6"     | 010310245        | 010310245A | 280mm 565mm |
| 114mm | 4 1/2" | 171mm 6 3/4" | 010311445        | 010311445A | 300mm 550mm |
| 127mm | 5"     | 203mm 8"     | 010312745        | 010312745A | 320mm 530mm |
| 152mm | 6"     | 229mm 9"     | 010315245        | 010315245A | 400mm 600mm |

## BENDS – 60° STANDARD

| OD x OD |        | CLR   |     | ALUMINISED STEEL | LEG LENGTH A |
|---------|--------|-------|-----|------------------|--------------|
| 89mm    | 3 1/2" | 127mm | 5"  | 900084A          | 203mm (8")   |
| 102mm   | 4"     | 127mm | 5"  | 900085A          | 203mm (8")   |
| 127mm   | 5"     | 152mm | 6"  | 900086A          | 203mm (8")   |
| 152mm   | 6"     | 254mm | 10" | 900087A          | 229mm (9")   |

- > Leg lengths ±5mm tolerance.
- > Bends can be manufactured to suit individual specifications.
- > Please Note: Minimum order quantities may apply.
- > Other tube sizes available for bending.
- > Mild Steel also available in 60° bends.

# BENDS

90° / 180°

## Bends - 90° standard

### Available in:

- > MILD STEEL
- > ALUMINISED STEEL (16 Gauge)
- > CHROME PLATED
- > STAINLESS STEEL (Type 304 & 316) (plain only)

> Also available expanded and notched.

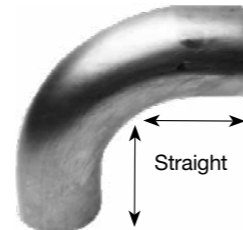

## Bends - 90° standard long leg

### Available in:

- > MILD STEEL
- > ALUMINISED STEEL

- > CLR = 1.5 x diameter.
- > 1.6mm Wall.
- > Leg lengths can be specially manufactured to suit individual specifications. Minimum order quantities may apply.
- > Also available in expanded, notched, short and long lengths.

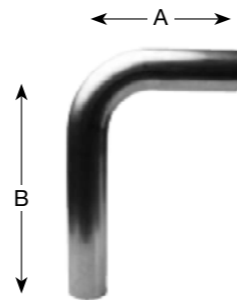

## Bends - 90° short radius

### Available in:

- > MILD STEEL
- > ALUMINISED STEEL (16 Gauge)
- > CHROME PLATED

- > For Use in tight places where clearance is a Problem. A
- > CLR = 1 x diameter.
- > Also available in expanded, notched, short and long lengths.

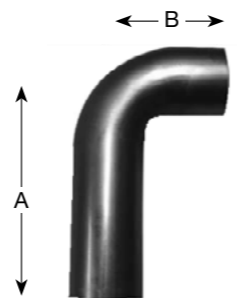

## Bends - 180° standard

### Available in:

- > MILD STEEL
- > ALUMINISED STEEL

- > 1.6mm Wall.
- > CLR = 1.5 x diameter.

Note: Leg lengths on 180° bends may not be equal. Refer to table opposite for leg lengths.



# BENDS

90° / 180°

## BENDS - 90° STANDARD

| OD           | CLR           | MILD STEEL | ALUMINISED STEEL | CHROME PLATED |                    | STAINLESS STEEL |            |
|--------------|---------------|------------|------------------|---------------|--------------------|-----------------|------------|
|              |               |            |                  | PLAIN         | EXPANDED - NOTCHED | TYPE 304        | TYPE 316   |
| 25mm 1"      | 38mm 1 1/2"   | 010102590  |                  |               |                    | 050102590H      | 050102590J |
| 29mm 1 1/4"  | 50mm 2"       | 010102990  |                  |               |                    |                 |            |
| 32mm 1 1/4"  | 48mm 1 7/8"   | 010103290  |                  |               |                    | 050103290H      | 050103290J |
| 35mm 1 3/8"  | 53mm 3"       | 010103590  |                  |               |                    |                 |            |
| 38mm 1 1/2"  | 57mm 2 1/4"   | 010103890  | 010103890A       |               |                    | 050103890H      | 050103890J |
| 41mm 1 5/8"  | 76mm 3"       | 010104190  | 010104190A       |               |                    |                 |            |
| 44mm 1 3/4"  | 66mm 2 3/5"   | 010104490  | 010104490A       |               |                    | 050104490H      | 050104490J |
| 48mm 1 7/8"  | 72mm 2 4/5"   | 010104890  | 010104890A       |               |                    |                 |            |
| 51mm 2"      | 76mm 3"       | 010105190  | 010105190A       |               |                    | 050105190H      | 050105190J |
| 57mm 2 1/4"  | 85mm 3 2/5"   | 010105790  | 010105790A       |               |                    |                 |            |
| 63mm 2 1/2"  | 95mm 3 3/4"   | 010106390  | 010106390A       | CPB06390      | CPB06390X          | 050106390H      | 050106390J |
| 70mm 2 3/4"  | 105mm 4 1/10" | 010107090  |                  |               |                    |                 |            |
| 76mm 3"      | 114mm 4 1/2"  | 010107690  | 010107690A       | CPB07690      | CPB07690X          | 050107690H      | 050107690J |
| 89mm 3 1/2"  | 134mm 5 1/4"  | 010108990  | 010108990A       | CPB08990      | CPB08990X          | 050108990H      | 050108990J |
| 102mm 4"     | 152mm 6"      | 010110290  | 010110290A       | CPB10290      | CPB10290X          | 050110190H      | 050110190J |
| 114mm 4 1/2" | 171mm 6 3/4"  | 010111490  | 010111490A       | CPB11490      | CPB11490X          |                 |            |
| 127mm 5"     | 203mm 8"      | 010112790  | 010112790A       | CPB12790      | CPB12790X          | 050112790H      | 050112790J |
| 152mm 6"     | 229mm 9"      | 010115290  | 010115290A       | CPB15290      | CPB15290X          | 050115290H      | 050115290J |

## BENDS - 90° STANDARD LONG LEG

| OD           | CLR          | MILD STEEL | ALUMINISED STEEL | CHROME PLATED |                    | LEG LENGTH |       |
|--------------|--------------|------------|------------------|---------------|--------------------|------------|-------|
|              |              |            |                  | PLAIN         | EXPANDED - NOTCHED | Short      | Long  |
| 63mm 2 1/2"  | 95mm 3 3/4"  | 010306390  | 010306390A       |               |                    | 284mm      | 500mm |
| 76mm 3"      | 114mm 4 1/2" | 010307690  | 010307690A       |               |                    | 295mm      | 600mm |
| 89mm 3 1/2"  | 134mm 5 1/4" | 010308990  | 010308990A       |               |                    | 300mm      | 600mm |
| 102mm 4"     | 152mm 6"     | 010310290  | 010310290A       | CPB10290E     | CPN10290EPX*       | 350mm      | 570mm |
| 114mm 4 1/2" | 171mm 6 3/4" | 010311490  | 010311490A       |               |                    | 388mm      | 543mm |
| 127mm 5"     | 203mm 8"     | 010312790  | 010312790A       | CPB12790E     | CPB12790EPX*       | 480mm      | 600mm |
| 152mm 6"     | 229mm 9"     | 010315290  | 010315290A       |               |                    | 400mm      | 600mm |

## BENDS - 90° SHORT RADIUS

| OD          | CLR          | MILD STEEL | ALUMINISED STEEL | CHROME PLATED |                    | CENTRE TO END<br>A x B |
|-------------|--------------|------------|------------------|---------------|--------------------|------------------------|
|             |              |            |                  | PLAIN         | EXPANDED - NOTCHED |                        |
| 63mm 2 1/2" | 63mm 2 1/2"  | 016006390  | 016006390A       | -             | -                  | 113 x 203mm            |
| 76mm 3"     | 76mm 3"      | 016007690  | 016007690A       | -             | -                  | 126 x 229mm            |
| 89mm 3 1/2" | 89mm 3 1/2"  | 016008990  | 016008990A       | -             | -                  | 165 x 229mm            |
| 102mm 4"    | 102mm 4"     | 016010290  | 016010290A       | CPB10290SR    | CPB10290SRX        | 178 x 254mm            |
| 127mm 5"    | 140mm 5 1/2" | 016012790  | 016012790A       | CPB12790SR    | CPB12790SRX        | 203 x 437mm            |
| 127mm 5"    | 140mm 5 1/2" |            |                  | CPB12790SR-L  | CPB12790SR-LX      | 330 x 330mm            |
| 152mm 6"    | 152mm 6"     | 016015290  | 016015290A       | CPB15290SR    | CPB15290SRX        | 254 x 254mm            |

## 180° STANDARD

| OD          | CLR           | MILD STEEL | ALUMINISED STEEL | LEG LENGTH |       |
|-------------|---------------|------------|------------------|------------|-------|
|             |               |            |                  | Short      | Long  |
| 25mm 1"     | 38mm 1 1/2"   | 0101025180 | -                | 101mm      | 101mm |
| 29mm 1 1/8" | 50mm 2"       | 0101029180 | -                | 120mm      | 120mm |
| 32mm 1 1/4" | 48mm 1 7/8"   | 0101032180 | -                | 122mm      | 122mm |
| 35mm 1 3/8" | 76mm 3"       | 0101035180 | -                | 180mm      | 180mm |
| 38mm 1 1/2" | 57mm 2 1/4"   | 0101038180 | 0101038180A      | 167mm      | 167mm |
| 41mm 1 5/8" | 76mm 3"       | 0101041180 | 0101041180A      | 177mm      | 177mm |
| 44mm 1 3/4" | 66mm 2 3/5"   | 0101044180 | 0101044180A      | 190mm      | 190mm |
| 48mm 1 7/8" | 72mm 2 4/5"   | 0101048180 | 0101048180A      | 198mm      | 198mm |
| 51mm 2"     | 76mm 3"       | 0101051180 | 0101051180A      | 202mm      | 202mm |
| 57mm 2 1/4" | 85mm 3 2/5"   | 0101057180 | 0101057180A      | 243mm      | 243mm |
| 63mm 2 1/2" | 95mm 3 3/4"   | 0101063180 | 0101063180A      | 290mm      | 290mm |
| 70mm 2 3/4" | 105mm 4 1/10" | 0101070180 | -                | 330mm      | 275mm |
| 76mm 3"     | 114mm 4 1/2"  | 0101076180 | 0101076180A      | 322mm      | 322mm |
| 89mm 3 1/2" | 134mm 5 1/4"  | 0101089180 | 0101089180A      | 415mm      | 340mm |
| 102mm 4"    | 153mm 6"      | 0101102180 | 0101102180A      | 255mm      | 255mm |

> Leg lengths ±5mm tolerance.



## Mild and aluminised steel

| TUBE DIAMETER | DIAMETER TOLERANCE ± mm | WALL THICKNESS mm | WALL TOLERANCE ± mm | OVALITY TOLERANCE mm |
|---------------|-------------------------|-------------------|---------------------|----------------------|
| 16mm          | 0.150                   | 1.600             | 0.200               | -                    |
| 19mm          | 0.150                   | 1.600             | 0.200               | -                    |
| 22mm          | 0.150                   | 1.600             | 0.200               | -                    |
| 25mm          | 0.200                   | 1.600             | 0.200               | -                    |
| 32mm          | 0.200                   | 1.600             | 0.200               | -                    |
| 35mm          | 0.200                   | 1.600             | 0.200               | -                    |
| 38mm          | 0.200                   | 1.600             | 0.200               | -                    |
| 41mm          | 0.200                   | 1.600             | 0.200               | -                    |
| 44mm          | 0.200                   | 1.600             | 0.200               | -                    |
| 48mm          | 0.200                   | 1.600             | 0.200               | -                    |
| 51mm          | 0.300                   | 1.600             | 0.200               | -                    |
| 57mm          | 0.300                   | 1.600             | 0.200               | -                    |
| 63mm          | 0.300                   | 1.600             | 0.200               | -                    |
| 70mm          | 0.300                   | 1.600             | 0.200               | -                    |
| 76mm          | 0.400                   | 1.600             | 0.200               | -                    |
| 89mm          | 0.400                   | 1.600             | 0.200               | -                    |
| 102mm         | 0.127                   | 1.575             | + .1016 - .0508     | 0.3556               |
| 114mm         | 0.127                   | 1.575             | + .1016 - .0508     | 0.4064               |
| 127mm         | 0.127                   | 1.575             | + .1016 - .0508     | 0.4318               |
| 140mm         | 0.127                   | 1.575             | + .1016 - .0508     | 0.4826               |
| 152mm         | 0.127                   | 1.575             | + .1016 - .0508     | 0.5080               |
| 178mm         | 0.381                   | 1.651             | 0.127               | 0.8890               |
| 203mm         | 0.381                   | 1.905             | 0.127               | 1.5240               |
| 254mm         | 0.508                   | 1.905             | 0.127               | 1.7800               |

➤ Tolerance Levels meet Standards AS1450-1983/C200/ERW, AS1866 and AS1867.

## Aluminium

| TUBE DIAMETER | DIAMETER TOLERANCE ± mm | WALL THICKNESS mm | WALL TOLERANCE ± mm | ALLOY | TEMPER |
|---------------|-------------------------|-------------------|---------------------|-------|--------|
| 102mm         | 0.130                   | 1.220             | 0.200               | 3004  | H33    |
| 102mm         | 0.130                   | 1.600             | 0.250               | 6060  | T5     |
| 127mm         | 0.130                   | 1.320             | 0.200               | 3004  | H33    |
| 127mm         | 0.130                   | 2.800             | 0.350               | 6060  | T5     |
| 152mm         | 0.190                   | 1.580             | 0.250               | 3004  | H33    |
| 152mm         | 0.190                   | 2.400             | 0.350               | 6060  | T5     |
| 178mm         | 0.190                   | 1.630             | 0.250               | 3004  | H26    |
| 203mm         | 2.600                   | 3.000             | 0.350               | 6063  | T5     |

➤ Aluminium Rigid Tube is available in various cut lengths. ie: 500, 750, 1000mm.

## Stainless steel

| TUBE DIAMETER | DIAMETER TOLERANCE ± mm | WALL THICKNESS mm | WALL TOLERANCE ± mm | OVALITY TOLERANCE mm |
|---------------|-------------------------|-------------------|---------------------|----------------------|
| 16mm          | 0.100                   | 1.600             | 0.160               | -                    |
| 19mm          | 0.100                   | 1.600             | 0.160               | -                    |
| 19mm          | 0.100                   | 1.200             | 0.120               | -                    |
| 22mm          | 0.100                   | 1.600             | 0.160               | -                    |
| 25mm          | 0.150                   | 1.600             | 0.160               | -                    |
| 25mm          | 0.150                   | 1.200             | 0.120               | -                    |
| 32mm          | 0.150                   | 1.600             | 0.160               | -                    |
| 32mm          | 0.150                   | 1.200             | 0.120               | -                    |
| 35mm          | 0.150                   | 1.600             | 0.160               | -                    |
| 35mm          | 0.150                   | 1.200             | 0.120               | -                    |
| 38mm          | 0.250                   | 1.600             | 0.160               | -                    |
| 38mm          | 0.250                   | 1.200             | 0.120               | -                    |
| 41mm          | 0.250                   | 1.200             | 0.120               | -                    |
| 44mm          | 0.250                   | 1.600             | 0.160               | -                    |
| 51mm          | 0.250                   | 1.600             | 0.160               | -                    |
| 51mm          | 0.250                   | 1.200             | 0.120               | -                    |
| 64mm          | 0.300                   | 1.600             | 0.160               | -                    |
| 64mm          | 0.300                   | 1.200             | 0.120               | -                    |
| 76mm          | 0.380                   | 1.600             | 0.160               | -                    |
| 89mm          | 0.380                   | 1.600             | 0.160               | -                    |
| 102mm         | 0.380                   | 1.600             | 0.160               | -                    |
| 127mm         | 0.760                   | 1.600             | 0.160               | -                    |
| 152mm         | 0.760                   | 1.600             | 0.160               | -                    |

➤ Stainless Steel Tube is available in T304 and T316.

➤ T316 is used in salty conditions.

## RIGID TUBE - HALF LENGTH

| TUBE OD | GAUGE mm | MILD STEEL | LENGTH mtr | ALUMINISED | LENGTH mtr | ALUMINIUM | LENGTH mtr | STAINLESS STEEL |          | LENGTH |
|---------|----------|------------|------------|------------|------------|-----------|------------|-----------------|----------|--------|
|         |          |            |            |            |            |           |            | 304             | 316      |        |
| 16mm    | 5/16"    | 1.6        | 0151016    | 3.05       | -          | -         | -          | -               | -        | -      |
| 19mm    | 3/4"     | 1.6        | 0151019    | 3.05       | -          | -         | -          | -               | -        | -      |
| 22mm    | 7/8"     | 1.6        | 0151022    | 3.05       | -          | -         | -          | -               | -        | -      |
| 25mm    | 1"       | 1.6        | 0151025    | 3.05       | -          | -         | -          | 0551025T        | 0552025T | 3      |
| 29mm    | 1 1/7"   | 1.6        | 0151029    | 3.05       | -          | -         | -          | -               | -        | -      |
| 32mm    | 1 1/4"   | 1.6        | 0151032    | 3.05       | -          | -         | -          | 0551032T        | 0552032T | 3      |
| 35mm    | 1 3/8"   | 1.6        | 0151035    | 3.05       | -          | -         | -          | -               | -        | -      |
| 38mm    | 1 1/2"   | 1.6        | 0151038    | 3.05       | 0152038    | 3.05      | -          | 0551038T        | 0552038T | 3      |
| 41mm    | 1 5/8"   | 1.6        | 0151041    | 3.05       | 0152041    | 3.05      | -          | -               | -        | -      |
| 44mm    | 1 3/4"   | 1.6        | 0151044    | 3.05       | 0152044    | 3.05      | -          | 0551044T        | 0552044T | 3      |
| 48mm    | 1 7/8"   | 1.6        | 0151048    | 3.05       | 0152048    | 3.05      | -          | -               | -        | -      |
| 51mm    | 2"       | 1.6        | 0151051    | 3.05       | 0152051    | 3.05      | -          | 0551051T        | 0552051T | 3      |
| 57mm    | 2 1/4"   | 1.6        | 0151057    | 3.05       | 0152057    | 3.05      | -          | -               | -        | -      |
| 63mm    | 2 1/2"   | 1.6        | 0151063    | 3.05       | 0152063    | 3.05      | -          | 0551063T        | 0552063T | 3      |
| 70mm    | 2 3/4"   | 1.6        | 0151070    | 3.05       | 929024A    | 3.00      | -          | -               | -        | -      |
| 76mm    | 3"       | 1.6        | 0151076    | 3.05       | 0152076    | 2.92      | -          | 0551076T        | 0552076T | 3      |
| 89mm    | 3 1/2"   | 1.6        | 0151089    | 3.05       | 0152089    | 2.92      | -          | 0551089T        | 0552089T | 3      |
| 102mm   | 4"       | 1.6        | 0151102    | 2.92       | 0152102    | 2.92      | 0154102    | 0551102T        | 0552102T | 3      |
| 114mm   | 4 1/2"   | 1.6        | 0151114    | 2.92       | 0152114    | 2.92      | -          | -               | -        | -      |
| 127mm   | 5"       | 1.32       | -          | -          | -          | 0154127   | 2.92       | -               | -        | 3      |
| 127mm   | 5"       | 1.6        | 0151127    | 2.92       | 0152127    | 2.92      | -          | 0551127T        | 0552127T | 3      |
| 127mm   | 5"       | 2.8        | -          | -          | -          | 0154127-1 | 3.25       | -               | -        | -      |
| 140mm   | 5 1/2"   | 1.6        | 0151140    | 2.92       | -          | 89663K    | 3.05       | -               | -        | -      |
| 152mm   | 6"       | 1.47       | -          | -          | -          | 0154152   | 2.92       | -               | -        | -      |
| 152mm   | 6"       | 1.6        | 0151152    | 2.92       | 0152152    | 2.92      | -          | 0551152T        | 0552152T | 3      |
| 152mm   | 6"       | 2.4        | -          | -          | -          | 0154152-1 | 3.25       | -               | -        | -      |
| 178mm   | 7"       | 1.52       | -          | -          | -          | 89665K    | 2.92       | -               | -        | -      |
| 178mm   | 7"       | 1.6        | 0151178    | 2.92       | 0152178    | 2.92      | -          | -               | -        | -      |
| 203mm   | 8"       | 1.63       | -          | -          | -          | 89666K    | 2.92       | -               | -        | -      |
| 203mm   | 8"       | 2.0        | -          | -          | -          | -         | -          | -               | -        | -      |
| 254mm   | 10"      | 2.0        | 0151254    | 2.92       | 0152254    | 2.92      | -          | TBA             | -        | -      |

## RIGID TUBE - FULL LENGTH

| TUBE OD | GAUGE mm | MILD STEEL | LENGTH mtr | ALUMINISED | LENGTH mtr | ALUMINIUM  | LENGTH mtr | STAINLESS STEEL |           | LENGTH |
|---------|----------|------------|------------|------------|------------|------------|------------|-----------------|-----------|--------|
|         |          |            |            |            |            |            |            | 304             | 316       |        |
| 16mm    | 5/16"    | 1.6        | 0151016F   | 6.1        | -          | -          | -          | -               | -         | -      |
| 19mm    | 3/4"     | 1.6        | 0151019F   | 6.1        | -          | -          | -          | -               | -         | -      |
| 22mm    | 7/8"     | 1.6        | 0151022F   | 6.1        | -          | -          | -          | -               | -         | -      |
| 25mm    | 1"       | 1.6        | 0151025F   | 6.1        | -          | -          | -          | 0551025FT       | 0552025FT | 6      |
| 29mm    | 1 1/7"   | 1.6        | 0151029F   | 6.1        | -          | -          | -          | -               | -         | -      |
| 32mm    | 1 1/4"   | 1.6        | 0151032F   | 6.1        | -          | -          | -          | 0551032FT       | 0552032FT | 6      |
| 35mm    | 1 3/8"   | 1.6        | 0151035F   | 6.1        | -          | -          | -          | -               | -         | -      |
| 38mm    | 1 1/2"   | 1.6        | 0151038F   | 6.1        | 0152038F   | 6.1        | -          | 0551038FT       | 0552038FT | 6      |
| 41mm    | 1 5/8"   | 1.6        | 0151041F   | 6.1        | 0152041F   | 6.1        | -          | -               | -         | -      |
| 44mm    | 1 3/4"   | 1.6        | 0151044F   | 6.1        | 0152044F   | 6.1        | -          | 0551044FT       | 0552044FT | 6      |
| 48mm    | 1 7/8"   | 1.6        | 0151048F   | 6.1        | 0152048F   | 6.1        | -          | -               | -         | -      |
| 51mm    | 2"       | 1.6        | 0151051F   | 6.1        | 0152051F   | 6.1        | -          | 0551051FT       | 0552051FT | 6      |
| 57mm    | 2 1/4"   | 1.6        | 0151057F   | 6.1        | 0152057F   | 6.1        | -          | -               | -         | -      |
| 63mm    | 2 1/2"   | 1.6        | 0151063F   | 6.1        | 0152063F   | 6.1        | -          | 0551063FT       | 0552063FT | 6      |
| 70mm    | 2 3/4"   | 1.6        | 0151070F   | 6.1        | -          | -          | -          | -               | -         | -      |
| 76mm    | 3"       | 1.6        | 0151076F   | 6.1        | 0152076F   | 5.84       | -          | 0551076FT       | 0552076FT | 6      |
| 89mm    | 3 1/2"   | 1.6        | 0151089F   | 6.1        | 0152089F   | 5.84       | -          | 0551089FT       | 0552089FT | 6      |
| 102mm   | 4"       | 1.6        | 0151102F   | 5.84       | 0152102F   | 5.84       | 0154102F   | 0551102FT       | 0552102FT | 6      |
| 114mm   | 4 1/2"   | 1.6        | 0151114F   | 5.84       | 0152114F   | 5.84       | -          | -               | -         | -      |
| 127mm   | 5"       | 1.32       | -          | -          | -          | 0154127F   | 5.84       | -               | -         | -      |
| 127mm   | 5"       | 1.6        | 0151127F   | 5.84       | 0152127F   | 5.84       | -          | 0551127FT       | 0552127FT | 6      |
| 127mm   | 5"       | 2.8        | -          | -          | -          | 0154127F-1 | 6.5        | -               | -         | -      |
| 140mm   | 5 1/2"   | 1.6        | 0151140F   | 5.84       | -          | -          | -          | -               | -         | -      |
| 152mm   | 6"       | 1.47       | -          | -          | -          | 0154152F   | 5.84       | -               | -         | -      |
| 152mm   | 6"       | 1.6        | 0151152F   | 5.84       | 0152152F   | 5.84       | -          | 0551152FT       | 0552152FT | 6      |
| 152mm   | 6"       | 2.4        | -          | -          | -          | 0154152F-1 | 6.5        | -               | -         | -      |
| 178mm   | 7"       | 1.52       | -          | -          | -          | 0154178F   | 5.84       | -               | -         | -      |
| 178mm   | 7"       | 1.6        | 0151178F   | 5.84       | 0152178F   | 5.84       | -          | -               | -         | -      |
| 203mm   | 8"       | 1.6        | -          | -          | -          | 0154203F   | 5.84       | -               | -         | -      |
| 203mm   | 8"       | 2.0        | -          | -          | -          | -          | -          | -               | -         | -      |
| 254mm   | 10"      | 2.0        | 0151254F   | 5.84       | 0152254F   | 5.84       | -          | -               | -         | -      |

➤ Cut lengths available to ord.

## Flex tube - full and pre-cut length

### Available in:

- > **GALVANISED**
- > **STAINLESS STEEL**

- > Flex hose should be installed in a 'partially compressed' state.
- > Flex lengths shown are partially compressed.
- > Flex should be installed in a straight position and not used as an elbow.
- > Larger diameters in alternate lengths are available on request.

**Note:** Cut lengths contain tack welds and are deburred both ends.

- > Cut lengths are nominal and minimum lengths.
- > Specific lengths can be cut to suit individual requirements on request. Offcuts included in sale.
- > **GALVANISED**
- > This type of flex tubing is capable of temperatures of up to 600°F (316°C) before the heat begins to breakdown the coating of the tube. At this point, the life of the tubing is limited and rust will begin to form.
- > **STAINLESS STEEL**
- > This type of flex is designed to take high temperatures, such as those found in diesel engine applications.
- > Stainless flex does have a tendency to discolour when exposed to these high-operating temperatures.



## Flex (bellows) connectors

- > STAINLESS STEEL corrugated with ALUMINISED STEEL connector ends.
- > Corrugated hose provides leak-proof flexible joints for critical applications. Maximum bend is 10°.
- > Higher tolerance for vibration and mis-alignment than flexible hose.
- > Available in OD / ID or ID / ID.
- > 18" in Length.



| FLEXIBLE TUBE - 3MTR LENGTH |     |                 |
|-----------------------------|-----|-----------------|
| ID TUBE                     |     | STAINLESS STEEL |
| 32mm                        | 1¼" | 0155032         |
| 38mm                        | 1½" | 0155038         |
| 42mm                        | 1⅝" | 0155042         |
| 45mm                        | 1⅞" | 0155045         |
| 48mm                        | 1⅞" | 0155048         |
| 51mm                        | 2"  | 0155051         |
| 57mm                        | 2¼" | 0155057         |
| 63mm                        | 2½" | 0155063         |
| 70mm                        | 2¾" | 0155070         |
| 76mm                        | 3"  | 0155076         |
| 89mm                        | 3½" | 0155089         |
| 102mm                       | 4"  | 0155102         |
| 114mm                       | 4½" | 0155114         |
| 127mm                       | 5"  | 0155127         |
| 152mm                       | 6"  | 0155152         |

| FLEXIBLE TUBE - PRE-CUT LENGTH |                 |            |
|--------------------------------|-----------------|------------|
| ID TUBE x LENGTH               | STAINLESS STEEL |            |
| 76mm x (3")                    | 300mm (12")     | SSF076X300 |
|                                | 450mm (18")     | SSF076X450 |
|                                | 600mm (24")     | SSF076X600 |
|                                | 750mm (30")     | SSF076X750 |
|                                | 900mm (36")     | SSF076X900 |
| 89mm x (3½")                   | 300mm (12")     | SSF089X300 |
|                                | 450mm (18")     | SSF089X450 |
|                                | 600mm (24")     | SSF089X600 |
|                                | 750mm (30")     | SSF089X750 |
|                                | 900mm (36")     | SSF089X900 |
| 102mm x (4")                   | 300mm (12")     | SSF102X300 |
|                                | 450mm (18")     | SSF102X450 |
|                                | 600mm (24")     | SSF102X600 |
|                                | 750mm (30")     | SSF102X750 |
|                                | 900mm (36")     | SSF102X900 |
| 114mm x (4½")                  | 300mm (12")     | SSF114X300 |
|                                | 450mm (18")     | SSF114X450 |
|                                | 600mm (24")     | SSF114X600 |
|                                | 750mm (30")     | SSF114X750 |
|                                | 900mm (36")     | SSF114X900 |
| 127mm x (5")                   | 300mm (12")     | SSF127X300 |
|                                | 450mm (18")     | SSF127X450 |
|                                | 600mm (24")     | SSF127X600 |
|                                | 750mm (30")     | SSF127X750 |
|                                | 900mm (36")     | SSF127X900 |

| FLEX (BELLOWS) CONNECTORS |     |                 |         |
|---------------------------|-----|-----------------|---------|
| DIAMETER                  |     | STAINLESS STEEL |         |
|                           |     | ID - ID         | ID - OD |
| 51mm                      | 2"  | -               | 89791K  |
| 63mm                      | 2½" | 89779K          | -       |
| 70mm                      | 2¾" | 89785K          | 89793K  |
| 76mm                      | 3"  | 89786K          | 89794K  |
| 89mm                      | 3½" | 89787K          | 89795K  |
| 102mm                     | 4"  | 89788K          | -       |
| 127mm                     | 5"  | 89789K          | -       |
| 152mm                     | 6"  | -               | -       |



## Guillotine

### Available in:

- > ZINC PLATED
- > CHROME PLATED
- > Forms 360° Seal.



## Flat band

### Available in:

- > ZINC PLATED
- > CHROME PLATED
- > 3/8" U-Bolt.
- > Selected sizes of zinc plated bulk packs are available in single units or bulk packs.



## Round U-bolt

### Available in:

- > Unfinished (MILD STEEL)
- > Standard 3/8" U-Bolt.



## Single bolt (AccuSeal™)

### Available in:

- > ALUMINISED STEEL
- > STAINLESS STEEL
- > Simple effective way to replace U-Bolt and Guillotine Clamps.
- > Creates over a tonne of clamping force without crushing pipes, resulting in strong, serviceable joint.

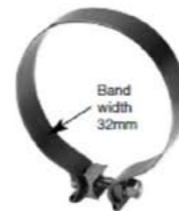

## Wide band (TorcTite™)

### > Lap type



### > Butt type



- > Available in either pre-formed TorcTite™ or EasySeal™ style. These clamps stop leaky gaps between both overlapping and butt joints. The unique reaction block design results in a strong, tightly sealed and reliable exhaust joint without the need for extra gaskets.
- > The positive clamping action allows the butt style TorcTite™ Clamp to be used on equal sized tubes without overlap.

## Spare parts for clamps

### > WBC001H

For wide band



## HEAVY DUTY CLAMPS

### PLAIN TUBING

| NOMINAL ID   | GUILLOTINE |        | FLAT   |        | ROUND                   |
|--------------|------------|--------|--------|--------|-------------------------|
|              | ZINC       | CHROME | ZINC   | CHROME | UNFINISHED (MILD STEEL) |
| 51mm 2"      | 89541K     | -      | -      | -      | 90929K                  |
| 57mm 2 1/4"  | 89542K     | -      | -      | -      | -                       |
| 63mm 2 1/2"  | 89543K     | -      | -      | -      | 90916K                  |
| 70mm 2 3/4"  | 89544K     | -      | -      | -      | -                       |
| 76mm 3"      | 89545K     | -      | 89556K | 89566K | 900041K                 |
| 83mm 3 1/4"  | 89546K     | -      | -      | -      | -                       |
| 89mm 3 1/2"  | 89547K     | -      | 89557K | -      | -                       |
| 102mm 4"     | 89548K     | -      | 89558K | 89568K | -                       |
| 114mm 4 1/2" | 90092A     | -      | -      | -      | -                       |
| 127mm 5"     | 89549K     | 89549C | 89559K | 89569K | 900044K                 |
| 140mm 5 1/2" | -          | -      | 90161K | -      | -                       |
| 152mm 6"     | 89550K     | -      | 89560K | 89570K | 900045K                 |

\* Bulk pack clamps available at a discounted rate.

### EXPANDED & NOTCHED TUBING (ID 3MM LARGER THAN NOMINAL ID)

| NOMINAL ID   | SINGLE BOLT |           | FLAT       |            | ROUND     |           |
|--------------|-------------|-----------|------------|------------|-----------|-----------|
|              | ALUMINISED  | STAINLESS | ZINC       | CHROME     | ZINC      | CHROME    |
| 45mm 1 7/8"  | -           | -         | -          | -          | 0161CZ045 | -         |
| 48mm 1 7/8"  | -           | -         | -          | -          | 0161CZ048 | -         |
| 51mm 2"      | 90869A      | 900016A * | -          | -          | 0161CZ051 | 0161CC051 |
| 54mm 2 1/8"  | -           | -         | -          | -          | 0161CZ054 | 0161CC054 |
| 57mm 2 1/4"  | 90870A      | 900017A * | -          | -          | 0161CZ057 | 0161CC057 |
| 63mm 2 1/2"  | 90871A      | 900018A * | -          | -          | 0161CZ063 | 0161CC063 |
| 70mm 2 3/4"  | 90872A      | 900019A * | -          | -          | -         | -         |
| 76mm 3"      | 90873A      | 900003A   | 0161CZ076F | 0161CC076F | 0161CZ076 | 0161CC076 |
| 89mm 3 1/2"  | 90874A      | 900004A   | 0161CZ089F | 0161CC089F | 0161CZ089 | 0161CC089 |
| 102mm 4"     | 90875A      | 90885A    | 0161CZ102F | 0161CC102F | 0161CZ102 | 0161CC102 |
| 114mm 4 1/2" | 90876A      | -         | 0161CZ114F | 0161CC114F | 0161CZ114 | 0161CC114 |
| 127mm 5"     | 90877A      | 90887A    | 0161CZ127F | 0161CC127F | 0161CZ127 | 0161CC127 |
| 127mm 5"     | -           | -         | 0161CZ127S | #          | -         | -         |
| 152mm 6"     | 90878A      | SBPC152S  | 0161CZ152F | 0161CC152F | 0161CZ152 | 0161CC152 |
| 178mm 7"     | -           | -         | 0161CZ178F | -          | -         | -         |
| 203mm 8"     | -           | -         | -          | -          | 0161CZ203 | -         |

\* T409 Metric

# 15mm saddle

| NOMINAL ID   | WIDE BAND  |           |            |           | FLAT BAND |
|--------------|------------|-----------|------------|-----------|-----------|
|              | LAP TYPE   |           | BUTT TYPE  |           |           |
|              | ALUMINISED | STAINLESS | ALUMINISED | STAINLESS | STAINLESS |
| 51mm 2"      | 90350A     | 90360A    | 0162140220 | 90380A    | 89521K    |
| 57mm 2 1/4"  | 90351A     | 90361A    | 0162140622 | 90381A    | 89522K    |
| 63mm 2 1/2"  | 90352A     | 90362A    | 0162141025 | 90382A    | 89523K    |
| 70mm 2 3/4"  | 90353A     | 90363A    | 0162141427 | 90383A    | 89524K    |
| 76mm 3"      | 90354A     | 90364A    | 0162141830 | 90384A    | 89525K    |
| 89mm 3 1/2"  | 90355A     | 90365A    | 0162142235 | 90385A    | 89526K    |
| 102mm 4"     | 90356A     | 90366A    | 0162142640 | 90386A    | 89527K    |
| 114mm 4 1/2" | 90357A     | 90367A    | 0162142845 | 90387A    | 90464K    |
| 127mm 5"     | 90358A     | 90368A    | 0162143050 | 90388A    | 89528K    |
| 152mm 6"     | 90359A     | 90369A    | 0162143460 | 90389A    | 89529K    |

# V-BAND CLAMPS

# V-BAND CLAMPS

- > V-Band Clamps are made of Type 321 Stainless Steel.
- > The function of a V-Band clamp is to connect the manifold or turbocharger to the exhaust system.
- > These type of clamps are designed to cater to the majority of engine applications and are available in a variety of sizes.

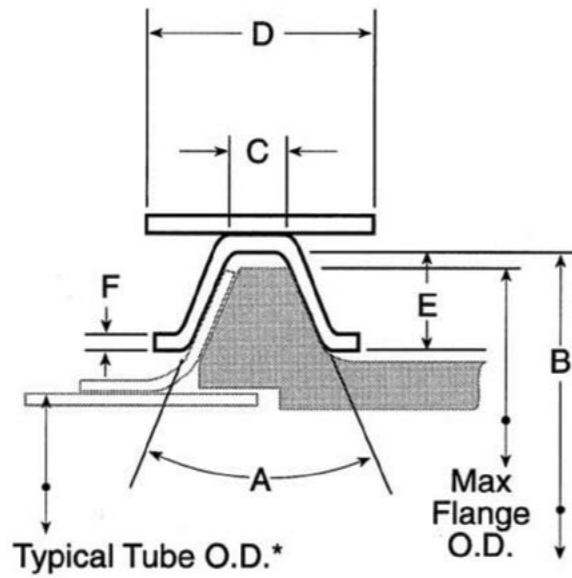

## CUMMINS

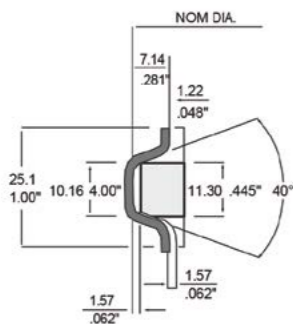

(wider)

## DETROIT

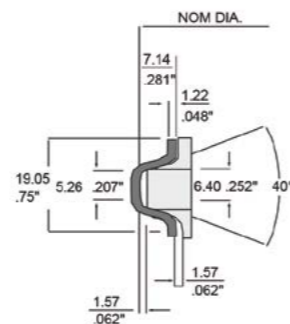

(narrower)

| V-BAND CLAMPS |             |  |     |               |              |              |             |               |               |
|---------------|-------------|--|-----|---------------|--------------|--------------|-------------|---------------|---------------|
| TUBE OD       | PART NUMBER | TYPICAL APPLICATION                                  | A   | B             | C            | D            | E           | F             | MAX FLANGE OD |
| 2.50"         | 90603K      | DD 8.2T 8920206                                      | 40° | 2.88<br>73mm  | .207<br>5mm  | .75<br>19mm  | .28<br>7mm  | .050<br>1mm   | 2.75<br>70mm  |
| 2.75"         | 89571K      | Cummins B  | 40° | 3.22<br>82mm  | 0.26<br>7mm  | 0.85<br>22mm | 0.14<br>4mm | 0.05<br>1mm   | 3.13<br>80mm  |
| 3.00"         | 89530K      | Ford D9HT-51210-DA                                   | 40° | 3.87<br>99mm  | 0.43<br>11mm | 0.88<br>22mm | 0.31<br>8mm | 0.08<br>2mm   | 3.75<br>95mm  |
| 3.00"         | 89505K      | DD 6V71  | 40° | 3.82<br>97mm  | 0.21<br>5mm  | 0.88<br>22mm | 0.28<br>7mm | 0.08<br>2mm   | 3.70<br>94mm  |
| 3.00"         | 89500K      | Cummins V903<br>Ford 370 & 429<br>E5HZ-5A321-B       | 40° | 3.88<br>99mm  | 0.40<br>10mm | 0.88<br>22mm | 0.28<br>7mm | 0.05<br>1mm   | 3.76<br>96mm  |
| 3.50"         | 89573K      | Cummins C  | 40° | 4.12<br>105mm | 0.26<br>7mm  | 0.67<br>17mm | 0.14<br>4mm | 0.05<br>1mm   | 4.03<br>102mm |
| 3.50"         | 89531K      | Cat 3208T<br>Ford 6.6, 7.8<br>E2HT5A212AA            | 40° | 4.19<br>106mm | 0.40<br>10mm | 0.88<br>22mm | 0.28<br>7mm | 0.05<br>1mm   | 4.07<br>103mm |
| 3.50"         | 89506K      | DD8V71   | 40° | 4.25<br>108mm | 0.40<br>10mm | 0.88<br>22mm | 0.28<br>7mm | 0.05<br>1mm   | 4.16<br>106mm |
| 3.50"         | 89501K      | Cummins VT555  | 40° | 4.25<br>108mm | 0.40<br>10mm | 0.88<br>22mm | 0.28<br>7mm | 0.05<br>1mm   | 4.16<br>106mm |
| 3.50"         | 89512K      | IH DT466 & Connector Ends                            | 40° | 4.31<br>109mm | .207<br>5mm  | .88<br>22mm  | .28<br>7mm  | .080<br>2mm   | 4.19<br>106mm |
| 4.00"         | 89508K      | DD 8.2N  | 40° | 4.06<br>103mm | 0.24<br>6mm  | 0.88<br>22mm | 0.29<br>7mm | 0.08<br>2mm   | 3.94<br>100mm |
| 4.00"         | 89520K      | Cat 3126T<br>Cat 3176T<br>Cummins L10<br>Cummins M11 | 40° | 4.75<br>121mm | 0.40<br>10mm | 1<br>25mm    | 0.28<br>7mm | 0.05<br>1mm   | 4.63<br>118mm |
| 4.00"         | 89509K      | DD 8.2T<br>GM 2295978                                | 40° | 4.75<br>121mm | 0.16<br>4mm  | 0.88<br>22mm | 0.31<br>8mm | 0.08<br>2mm   | 4.63<br>118mm |
| 4.00"         | 89532K      | Mack 11ME29  | 40° | 4.94<br>126mm | 0.18<br>5mm  | 0.75<br>19mm | 0.28<br>7mm | 0.06<br>2mm   | 4.82<br>122mm |
| 4.00"         | 89502K      | Switzer 4LDE,<br>4LE, 4LH, 4LS                       | 40° | 4.50<br>114mm | 0.26<br>7mm  | 0.75<br>19mm | 0.14<br>4mm | 0.05<br>1mm   | 4.41<br>112mm |
| 4.00"         | 89507K      | DD 6-71  | 40° | 4.91<br>125mm | 0.29<br>7mm  | 1.13<br>29mm | 0.30<br>8mm | 0.09<br>2mm   | 4.79<br>122mm |
| 4.00"         | 89533K      | Mack 48RU2341  | 40° | 4.61<br>117mm | 0.16<br>4mm  | 0.75<br>19mm | 0.22<br>6mm | 0.05<br>1mm   | 4.49<br>114mm |
| 4.00"         | 89513K      | Connector Ends                                       | 40° | 4.81<br>122mm | .207<br>5mm  | .88<br>22mm  | .28<br>7mm  | .080<br>2mm   | 4.69<br>119mm |
| 4.88"         | 89510K      | DD 8V71T<br>6V92T<br>8V92T                           | 40° | 5.25<br>133mm | 0.26<br>7mm  | 0.75<br>19mm | 0.14<br>4mm | 0.05<br>1mm   | 5.16<br>131mm |
| 5.00"         | 89503K      | Cummins T50<br>Turbo, M-11                           | 40° | 5.88<br>149mm | 0.40<br>10mm | 0.88<br>22mm | 0.28<br>7mm | 0.05<br>1mm   | 5.79<br>147mm |
| 5.00"         | 89514K      | Connector Ends                                       | 40° | 5.81<br>148mm | 0.21<br>5mm  | 0.88<br>22mm | 0.28<br>7mm | 0.08<br>2mm   | 5.69<br>145mm |
| 5.00"         | 90530K      | DD 8V71 Special Manifold                             | 40° | 5.87<br>149mm | 0.37<br>9mm  | 0.88<br>22mm | 0.30<br>8mm | 0.05<br>1mm   | 5.75<br>146mm |
| 5.25"         | 89504K      | T50 Housing  | 40° | 6.76<br>172mm | 1.67<br>42mm | 1.88<br>48mm | .281<br>7mm | .060<br>1.5mm | 6.64<br>169mm |



## Single couplers

| OD / ID | OVERALL LENGTH | EXPANDED LENGTH |
|---------|----------------|-----------------|
| 51mm    | 100mm          | 55mm            |
| 57mm    | 100mm          | 55mm            |
| 63mm    | 100mm          | 55mm            |
| 70mm    | 105mm          | 56mm            |
| 76mm    | 102mm          | 62mm            |
| 89mm    | 102mm          | 60mm            |
| 102mm   | 105mm          | 65mm            |
| 114mm   | 102mm          | 60mm            |
| 127mm   | 102mm          | 60mm            |
| 140mm   | 100mm          | 55mm            |
| 152mm   | 102mm          | 60mm            |

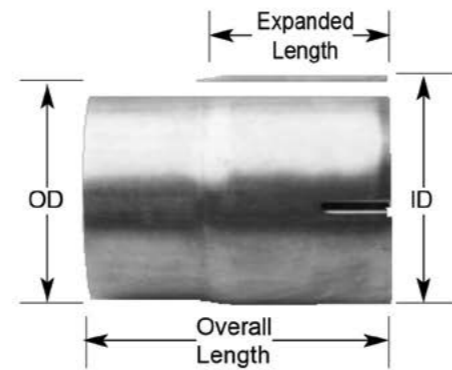

- > Weld one end, U-Bolt other.
- > Connects OD and ID pipes of the same size.

## Straight tube couplers

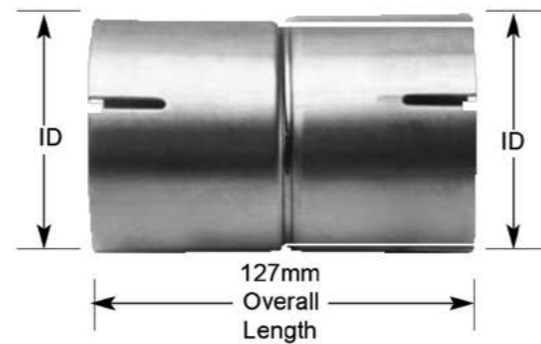

- > U-Bolt both ends.
- > Connects OD pipes of the same size.

## Lipped flange

| OD    | FLARED OD | OVERALL LENGTH |
|-------|-----------|----------------|
| 51mm  | 66mm      | 70mm           |
| 57mm  | 71mm      | 70mm           |
| 63mm  | 80mm      | 70mm           |
| 76mm  | 91mm      | 78mm           |
| 89mm  | 105mm     | 76mm           |
| 102mm | 119mm     | 78mm           |
| 114mm | 131mm     | 80mm           |
| 127mm | 144mm     | 80mm           |
| 152mm | 175mm     | 78mm           |

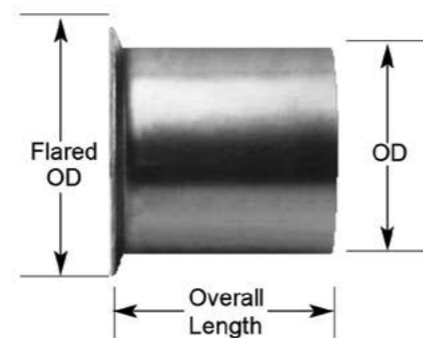

- > Designed for use with V-Band Clamps.
- > Standard 20° lip angle.

## SINGLE COUPLERS

| DIMENSIONAL DATA<br>OD / ID | MILD STEEL | ALUMINISED STEEL | STAINLESS STEEL |          |
|-----------------------------|------------|------------------|-----------------|----------|
|                             |            |                  | TYPE 304        | TYPE 316 |
| 51mm 2"                     | 0111SC051  | 0111SC051A       | SC051.S         | SC051.SS |
| 57mm 2¼"                    | 0111SC057  | 0111SC057A       | -               | -        |
| 63mm 2½"                    | 0111SC063  | 0111SC063A       | SC063.S         | SC063.SS |
| 70mm 2¾"                    | 0111SC070  | 0111SC070A       | -               | -        |
| 76mm 3"                     | 0111SC076  | 0111SC076A       | SC076.S         | SC076.SS |
| 89mm 3½"                    | 0111SC089  | 0111SC089A       | SC089.S         | SC089.SS |
| 102mm 4"                    | 0111SC102  | 0111SC102A       | SC102.S         | SC102.SS |
| 114mm 4½"                   | 0111SC114  | 0111SC114A       | -               | -        |
| 127mm 5"                    | 0111SC127  | 0111SC127A       | SC127.S         | SC127.SS |
| 140mm 5½"                   | 0111SC140  | 0111SC140A       | -               | -        |
| 152mm 6"                    | 0111SC152  | 0111SC152A       | SC152.S         | SC152.SS |

## STRAIGHT TUBE COUPLERS

| DIMENSIONAL DATA<br>ID / ID | MILD STEEL | ALUMINISED STEEL | STAINLESS STEEL |           |
|-----------------------------|------------|------------------|-----------------|-----------|
|                             |            |                  | TYPE 304        | TYPE 316  |
| 51mm 2"                     | 0111TC051  | 0111TC051A       | STC051.S        | STC051.SS |
| 57mm 2¼"                    | 0111TC057  | 0111TC057A       | -               | -         |
| 63mm 2½"                    | 0111TC063  | 0111TC063A       | STC063.S        | STC063.SS |
| 70mm 2¾"                    | 0111TC070  | 0111TC070A       | -               | -         |
| 76mm 3"                     | 0111TC076  | 0111TC076A       | STC076.S        | STC076.SS |
| 89mm 3½"                    | 0111TC089  | 0111TC089A       | STC089.S        | STC089.SS |
| 102mm 4"                    | 0111TC102  | 0111TC102A       | STC102.S        | STC102.SS |
| 114mm 4½"                   | 0111TC114  | 0111TC114A       | -               | -         |
| 127mm 5"                    | 0111TC127  | 0111TC127A       | STC127.S        | STC127.SS |
| 140mm 5½"                   | 0111TC140  | 0111TC140A       | -               | -         |
| 152mm 6"                    | 0111TC152  | 0111TC152A       | STC152.S        | STC152.SS |

## LIPPED FLANGE

| DIMENSIONAL DATA<br>OD / OD | MILD STEEL | ALUMINISED STEEL        | STAINLESS STEEL |          |
|-----------------------------|------------|-------------------------|-----------------|----------|
|                             |            |                         | TYPE 304        | TYPE 316 |
| 51mm 2"                     | 0111LF051  | 0111LF051A              | LF051.S         | LF051.SS |
| 57mm 2¼"                    | 0111LF057  | 0111LF057A              | -               | -        |
| 63mm 2½"                    | 0111LF063  | 0111LF063A              | LF063.S         | LF063.SS |
| 70mm 2¾"                    | 0111LF070  | 0111LF070A              | -               | -        |
| 76mm 3"                     | 0111LF076  | 0111LF076A              | LF076.S         | LF076.SS |
| 89mm 3½"                    | 0111LF089  | 0111LF089A              | LF089.S         | LF089.SS |
| 89mm 3½"                    |            | LF089AS (30mm length)   |                 |          |
| 102mm 4"                    | 0111LF102  | 0111LF102A              | LF102.S         | LF102.SS |
| 102mm 4"                    |            | LF102AS (30mm length)   |                 |          |
| 114mm 4½"                   | 0111LF114  | 0111LF114A              | -               | -        |
| 127mm 5"                    | 0111LF127  | 0111LF127A              | LF127.S         | LF127.SS |
| 127mm 5"                    |            | LF127AS (30mm length)   |                 |          |
| 127mm 5"                    |            | LF127AS80 (80mm length) |                 |          |
| 140mm 5½"                   | 0111LF140  | 0111LF140A              | -               | -        |
| 152mm 6"                    | 0111LF152  | 0111LF152A              | LF152.S         | LF152.SS |

## Expanded lipped flange

| OD / ID | FLARED OD | OVERALL LENGTH | EXPANDED LENGTH |
|---------|-----------|----------------|-----------------|
| 51mm    | 66mm      | 75mm           | 30mm            |
| 57mm    | 71mm      | 75mm           | 30mm            |
| 63mm    | 80mm      | 70mm           | 30mm            |
| 76mm    | 91mm      | 80mm           | 30mm            |
| 89mm    | 105mm     | 75mm           | 30mm            |
| 102mm   | 119mm     | 82mm           | 35mm            |
| 127mm   | 144mm     | 80mm           | 35mm            |
| 152mm   | 175mm     | 75mm           | 25mm            |

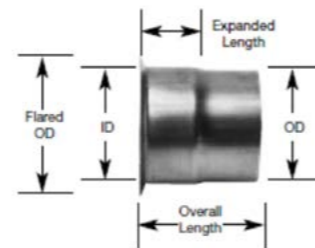

- › Designed for use with V-Band Clamps.
- › Standard 20° lip angle.

## Expanded couplers

| ID X ID     | OVERALL LENGTH | EXPANDED LENGTH (A) | EXPANDED LENGTH (B) |
|-------------|----------------|---------------------|---------------------|
| 51 x 57mm   | 127mm          | 60mm                | 55mm                |
| 51 x 63mm   | 127mm          | 60mm                | 50mm                |
| 51 x 76mm   | 135mm          | 65mm                | 42mm                |
| 57 x 63mm   | 130mm          | 70mm                | 55mm                |
| 57 x 76mm   | 135mm          | 57mm                | 45mm                |
| 63 x 70mm   | 135mm          | 50mm                | 75mm                |
| 63 x 76mm   | 130mm          | 55mm                | 65mm                |
| 70 x 76mm   | 140mm          | 60mm                | 75mm                |
| 76 x 89mm   | 127mm          | 60mm                | 55mm                |
| 76 x 102mm  | 127mm          | 55mm                | 45mm                |
| 89 x 102mm  | 127mm          | 55mm                | 60mm                |
| 102 x 114mm | 127mm          | 50mm                | 45mm                |
| 102 x 127mm | 127mm          | 50mm                | 45mm                |
| 110 x 127mm | 127mm          | 50mm                | 60mm                |
| 114 x 127mm | 127mm          | 65mm                | 55mm                |
| 127 x 140mm | 127mm          | 65mm                | 55mm                |
| 127 x 152mm | 127mm          | 55mm                | 45mm                |

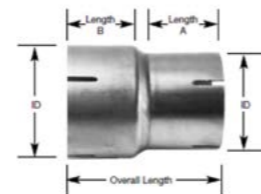

- U-Bolt each end.
- Reduces OD pipes of different sizes.

- › U-Bolt each end.
- › Reduces OD pipes of different sizes.

## Expanded adaptor

| OD X OD     | OVERALL LENGTH | UNEXPANDED LENGTH (A) | UN EXPANDED LENGTH (B) |
|-------------|----------------|-----------------------|------------------------|
| 51 x 57mm   | 127mm          | 60mm                  | 55mm                   |
| 51 x 63mm   | 127mm          | 60mm                  | 50mm                   |
| 51 x 76mm   | 135mm          | 65mm                  | 42mm                   |
| 57 x 63mm   | 130mm          | 70mm                  | 55mm                   |
| 57 x 76mm   | 135mm          | 57mm                  | 45mm                   |
| 63 x 70mm   | 135mm          | 50mm                  | 75mm                   |
| 63 x 76mm   | 130mm          | 55mm                  | 65mm                   |
| 70 x 76mm   | 140mm          | 60mm                  | 75mm                   |
| 76 x 89mm   | 127mm          | 60mm                  | 55mm                   |
| 76 x 102mm  | 127mm          | 55mm                  | 45mm                   |
| 89 x 102mm  | 127mm          | 55mm                  | 60mm                   |
| 102 x 114mm | 127mm          | 50mm                  | 45mm                   |
| 102 x 127mm | 127mm          | 50mm                  | 45mm                   |
| 110 x 127mm | 127mm          | 50mm                  | 60mm                   |
| 114 x 127mm | 127mm          | 65mm                  | 55mm                   |
| 127 x 140mm | 127mm          | 65mm                  | 55mm                   |
| 127 x 152mm | 127mm          | 55mm                  | 45mm                   |

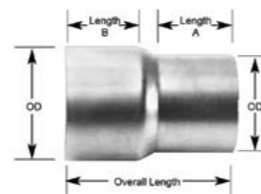

- Butt weld each end
- Reduces larger OD pipe to smaller OD pipe

- › Butt weld each end.
- › Reduces larger OD pipe to smaller OD pipe.

## EXPANDED LIPPED FLANGE

| ID / OD DATA | MILD STEEL | ALUMINISED STEEL | STAINLESS STEEL |           |
|--------------|------------|------------------|-----------------|-----------|
|              |            |                  | TYPE 304        | TYPE 316  |
| 51mm 2"      | 0111LX051  | 0111LX051A       | XLF051.S        | LF051.SS  |
| 57mm 2 1/4"  | 0111LX057  | 0111LX057A       | -               | -         |
| 63mm 2 1/2"  | 0111LX063  | 0111LX063A       | XLF063.S        | XLF063.SS |
| 70mm 2 3/4"  | 0111LX070  | 0111LX070A       | -               | -         |
| 76mm 3"      | 0111LX076  | 0111LX076A       | XLF076.S        | XLF076.SS |
| 89mm 3 1/2"  | 0111LX089  | 0111LX089A       | XLF089.S        | XLF089.SS |
| 102mm 4"     | 0111LX102  | 0111LX102A       | XLF102.S        | XLF102.SS |
| 114mm 4 1/2" | 0111LX114  | 0111LX114A       | -               | -         |
| 127mm 5"     | 0111LX127  | 0111LX127A       | XLF127.S        | XLF127.SS |
| 140mm 5 1/2" | 0111LX140  | 0111LX140A       | -               | -         |
| 152mm 6"     | 0111LX152  | 0111LX152A       | XLF152.S        | XLF152.SS |

## EXPANDED COUPLERS

| ID / ID DATA                | MILD STEEL  | ALUMINISED STEEL | STAINLESS STEEL |           |
|-----------------------------|-------------|------------------|-----------------|-----------|
|                             |             |                  | TYPE 304        | TYPE 316  |
| 38 (1 1/2") x 51mm (2")     | 0111XA0382X | -                | -               | -         |
| 51 (2") x 57mm (2 1/4")     | 0111XA0511X | 0111XA0511XA     | XC0511.S        | XC0511.SS |
| 63mm (2 1/2")               | 0111XA0512X | 0111XA0512XA     | XC0512.S        | XC0512.SS |
| 76mm (3")                   | 0111XA0513X | 0111XA0513XA     | XC0513.S        | XC0513.SS |
| 57 (2 1/4") x 63mm (2 1/2") | 0111XA057X  | 0111XA057XA      | -               | -         |
| 76mm (3")                   | 0111XA0571X | 0111XA0571XA     | -               | -         |
| 63 (2 1/2") x 70mm (2 3/4") | 0111XA0631X | 0111XA0631XA     | XC0631.S        | XC0631.SS |
| 76mm (3")                   | 0111XA063X  | 0111XA063XA      | XC063.S         | XC063.SS  |
| 70 (2 3/4") x 76mm (3")     | 0111XA070X  | -                | -               | -         |
| 76 (3") x 89mm (3 1/2")     | 0111XA0761X | 0111XA0761XA     | XC0761.S        | XC0761.SS |
| 102mm (4")                  | 0111XA0762X | 0111XA0762XA     | XC0762.S        | XC0762.SS |
| 89 (3 1/2") x 102mm (4")    | 0111XA089X  | 0111XA089XA      | XC089.S         | XC089.SS  |
| 102 (4") x 114mm (4 1/2")   | 0111XA1021X | 0111XA1021XA     | XC1021.S        | XC1021.SS |
| 127mm (5")                  | 0111XA102X  | 0111XA102XA      | XC102.S         | XC102.SS  |
| 110 (4 1/4") x 127mm (5")   | 0111XA110X  | 0111XA110XA      | -               | -         |
| 114 (4 1/2") x 127mm (5")   | 0111XA114X  | 0111XA114XA      | -               | -         |
| 127 (5") x 140mm (5 1/2")   | 0111XA1271X | 0111XA1271XA     | XC1271.S        | XC1271.SS |
| 152mm (6")                  | 0111XA127X  | 0111XA127XA      | XC127.S         | XC127.SS  |

## EXPANDED ADAPTORS

| OD / OD DATA                | MILD STEEL | ALUMINISED STEEL | STAINLESS STEEL |           |
|-----------------------------|------------|------------------|-----------------|-----------|
|                             |            |                  | TYPE 304        | TYPE 316  |
| 38 (1 1/2") x 51mm (2")     | 0111XA0382 | -                | -               | -         |
| 51 (2") x 57mm (2 1/4")     | 0111XA0511 | 0111XA0511A      | XA0511.S        | XA0511.SS |
| 63mm (2 1/2")               | 0111XA0512 | 0111XA0512A      | XA0512.S        | XA0512.SS |
| 76mm (3")                   | 0111XA0513 | 0111XA0513A      | XA0513.S        | XA0513.SS |
| 57 (2 1/4") x 63mm (2 1/2") | 0111XA057  | 0111XA057A       | -               | -         |
| 76mm (3")                   | 0111XA0571 | 0111XA0571A      | -               | -         |
| 63 (2 1/2") x 70mm (2 3/4") | 0111XA0631 | 0111XA0631A      | XA0631.S        | XA0631.SS |
| 76mm (3")                   | 0111XA063  | 0111XA063A       | XA063.S         | XA063.SS  |
| 70 (2 3/4") x 76mm (3")     | 0111XA070  | -                | -               | -         |
| 76 (3") x 89mm (3 1/2")     | 0111XA0761 | 0111XA0761A      | XA0761.S        | XA0761.SS |
| 102mm (4")                  | 0111XA0762 | 0111XA0762A      | XA0762.S        | XA0762.SS |
| 89 (3 1/2") x 102mm (4")    | 0111XA089  | 0111XA089A       | XA089.S         | XA089.SS  |
| 102 (4") x 114mm (4 1/2")   | 0111XA1021 | 0111XA1021A      | XA1021.S        | XA1021.SS |
| 127mm (5")                  | 0111XA102  | 0111XA102A       | XA102.S         | XA102.SS  |
| 110 (4 1/4") x 127mm (5")   | 0111XA110  | 0111XA110A       | -               | -         |
| 114 (4 1/2") x 127mm (5")   | 0111XA114  | 0111XA114A       | -               | -         |
| 127 (5") x 140mm (5 1/2")   | 0111XA1271 | 0111XA1271A      | XA1271.S        | XA1271.SS |
| 152mm (6")                  | 0111XA127  | 0111XA127A       | XA127.S         | XA127.SS  |



## Splitter tee adaptor pipe

### Available in:

#### > ALUMINISED STEEL

- > Converts a single system exhaust pipe into a dual system.
- > Purpose of 'Y' Junction to provide equal gas flow in both exhaust stacks.

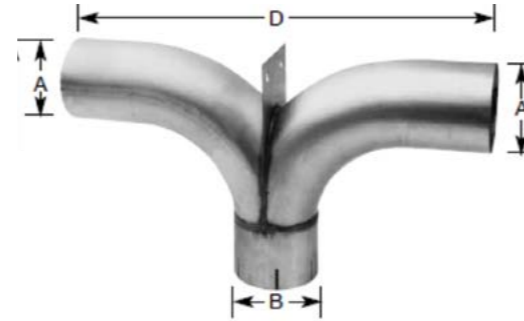

## 'Y' junctions

### Available in:

- > MILD STEEL
- > ALUMINISED STEEL
- > CHROME PLATED

- > Converts a single system exhaust pipe into a dual system.
- > Purpose of 'Y' Junction to provide equal gas flow in both exhaust stacks.

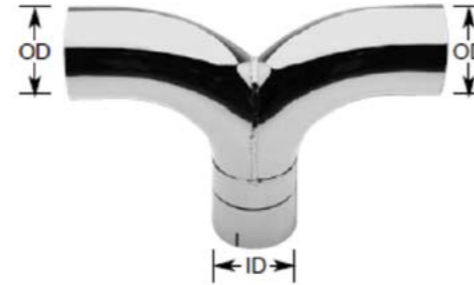

## 45° expanded junction

### Available in:

- > MILD STEEL
- > ALUMINISED STEEL

- > Can be used to convert a dual exhaust to single exhaust system.



## Cones

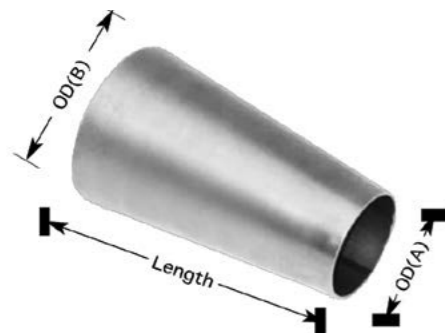

- > Can be used to convert a dual exhaust to single exhaust system.

## Donuts

CLR = 1 x diameter



- > Used where special angles are required.
- > Cut angles are available for special orders.

## SPLITTER TEE ADAPTOR PIPE

|            | A(OD) | B(ID) | C    | D   | ALUMINISED |
|------------|-------|-------|------|-----|------------|
| 102mm (4") | 4"    | 4"    | 11¼" | 16" | 89940A     |
| 127mm (5") | 5"    | 5"    | 14"  | 25" | 89950A     |

## 'Y' JUNCTION

| OD x 2 x ID | MILD STEEL | ALUMINISED STEEL | CHROME PLATED |
|-------------|------------|------------------|---------------|
| 63mm        | 0111JY063  | 0111JY063A       | -             |
| 76mm        | 0111JY076  | 0111JY076A       | -             |
| 89mm        | 0111JY089  | 0111JY089A       | -             |
| 102mm       | 0111JY102  | 0111JY102A       | 0111JY102C    |
| 114mm       | 0111JY114  | 0111JY114A       | 0111JY114C    |
| 127mm       | 0111JY127  | 0111JY127A       | 0111JY127C    |
| 152mm       | 0111JY152  | 0111JY152A       | 0111JY152C    |

## BEADED COUPLER

| OD / OD | MILD STEEL | ALUMINISED STEEL |
|---------|------------|------------------|
| 102mm   | BC102      | BC102A           |
| 114mm   | BC114V     | -                |
| 127mm   | BC127      | BC127A           |

## TUBE CONNECTOR, CLAMP & FLANGE KIT

|            | CLAMP  | CLAMP & FLANGE KIT |
|------------|--------|--------------------|
| 89mm (3½") | 89512K | -                  |
| 102mm (4") | 89513K | -                  |
| 127mm (5") | 89503K | -                  |

\* Kit includes two flanges and the V-Band clamp.

## 45° EXPANDED JUNCTION

| DIAMETER A (ID) | DIAMETER B (OD) | LENGTH C | LENGTH D | MILD STEEL | ALUMINISED STEEL |
|-----------------|-----------------|----------|----------|------------|------------------|
| 51mm            | 76mm            | 241.5mm  | 159mm    | 0111JX051  | -                |
| 57mm            | 76mm            | 254mm    | 159mm    | 0111JX057  | 0111JX057A       |
| 63mm            | 102mm           | 267mm    | 178mm    | 0111JX063  | 0111JX063A       |
| 76mm            | 102mm           | 279.5mm  | 190.5mm  | 0111JX076  | 0111JX076A       |
| 89mm            | 127mm           | 292mm    | 209.5mm  | 0111JX089  | 0111JX089A       |
| 102mm           | 127mm           | 317.5mm  | 216mm    | 0111JX102  | 0111JX102A       |

## CONES

| OD (A) | OD (B) | LENGTH | MILD STEEL | ALUMINISED STEEL |
|--------|--------|--------|------------|------------------|
| 51mm   | 76mm   | 92mm   | -          | CONE010A         |
| 51mm   | 76mm   | 127mm  | CONE001    | -                |
| 76mm   | 102mm  | 195mm  | CONE002    | -                |
| 89mm   | 127mm  | 152mm  | CONE003    | -                |
| 70mm   | 127mm  | 110mm  | CONE007    | -                |
| 102mm  | 152mm  | 149mm  | CONE005    | -                |

## DONUTS

| TUBE DIAMETER | GAUGE | MILD STEEL |            |            | S/STEEL 360° | ALUMINIUM 360° |
|---------------|-------|------------|------------|------------|--------------|----------------|
|               |       | 45°        | 90°        | 360°       |              |                |
| 51mm          | 2"    | 1.6mm      | 0190051D90 | 0190051    | -            | -              |
| 57mm          | 2¼"   | 1.6mm      | -          | 0190057    | SSD057       | -              |
| 63mm          | 2½"   | 1.6mm      | 0190063D90 | 0190063    | SSD063       | -              |
| 76mm          | 3"    | 2.0mm      | 0190076D90 | 0190076    | SSD076       | -              |
| 89mm          | 3½"   | 2.0mm      | 0190089D90 | 0190089    | SSD089       | -              |
| 102mm         | 4"    | 2.0mm      | 0190102D90 | 0190102    | SSD102       | ALD102         |
| 102mm         | 4"    | 3.0mm      | -          | -          | -            | ALD102-1       |
| 114mm         | 4½"   | 2.0mm      | -          | 0190114    | -            | -              |
| 127mm         | 5"    | 2.0mm      | 0190127D90 | 0190127    | SSD127       | ALD127         |
| 152mm         | 6"    | 2.0mm      | 0190152D90 | 0190152    | SSD152       | ALD152         |
| 152mm         | 6"    | 3.0mm      | -          | -          | -            | ALD152-1       |
| 178mm         | 7"    | 2.0mm      | 0190178D45 | 0190178D90 | 0190178      | -              |
| 203mm         | 8"    | 2.5mm      | 0190203D45 | 0190203D90 | 0190203      | SSD203         |
| 203mm         | 8"    | 3.0mm      | -          | -          | -            | -              |
| 254mm         | 10"   | 2.5mm      | 0190254D45 | 0190254D90 | 0190254      | ALD203         |

\* Alternative donut angles are available to suit individual requirements. Minimum order quantities may apply.

## Tilt cab connectors



Female Male

Available in:

- > MILD STEEL
- > ALUMINISED STEEL

## Special tilt cab connectors



Female Male

Available in:

- > MILD STEEL
- > ALUMINISED STEEL

> Available for purchase as a set or individually.

## Tilt cab bend assembly



Available in:

- > MILD STEEL
- > ALUMINISED STEEL
- > CHROME PLATED

## Stainless steel milk bends

Available in:

- > STAINLESS STEEL (T304)
- MIRROR FINISH

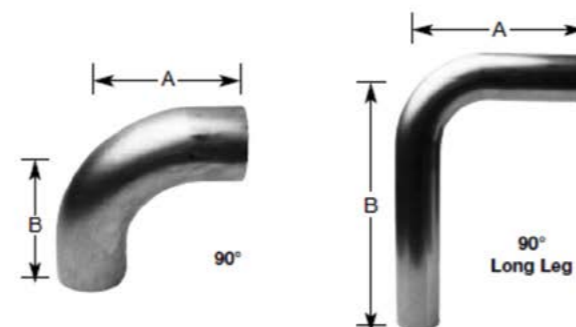

• As used in Dairy Industry.

| TILT CAB CONNECTORS |        |             |                  |
|---------------------|--------|-------------|------------------|
| TUBE OD             | TYPE   | MILD STEEL  | ALUMINISED STEEL |
| 102mm               | SET    | 0111TCC102  | 0111TCC102A      |
| 102mm               | FEMALE | 0111TCC102F | 0111TCC102FA     |
| 102mm               | MALE   | 0111TCC102M | 0111TCC102MA     |
| 127mm               | SET    | 0111TCC127  | 0111TCC127A      |
| 127mm               | FEMALE | 0111TCC127F | 0111TCC127FA     |
| 127mm               | MALE   | 0111TCC127M | 0111TCC127MA     |
| 152mm               | SET    | 0111TCC152  | 0111TCC152A      |
| 152mm               | FEMALE | 0111TCC152F | 0111TCC152FA     |
| 152mm               | MALE   | 0111TCC152M | 0111TCC152MA     |

| SPECIAL TILT CAB CONNECTORS |        |             |                  |
|-----------------------------|--------|-------------|------------------|
| TUBE OD                     | TYPE   | MILD STEEL  | ALUMINISED STEEL |
| 102mm                       | SET    | 0111TCS102  | -                |
| 102mm                       | FEMALE | 0111TCS102F | -                |
| 102mm                       | MALE   | 0111TCS102M | -                |
| 127mm                       | SET    | 0111TCS127  | 0111TCS127A      |
| 127mm                       | FEMALE | 0111TCS127F | 0111TCS127FA     |
| 127mm                       | MALE   | 0111TCS127M | 0111TCS127MA     |

Special Tilt Cab Connectors are manufactured to closer tolerances to provide an extra positive gas tight seal.

| TILT CAB BED ASSEMBLY |            |                  |               |
|-----------------------|------------|------------------|---------------|
| TUBE OD               | MILD STEEL | ALUMINISED STEEL | CHROME PLATED |
| 102mm                 | 011310290  | 011310290A       | 011310290C    |
| 127mm                 | 011312790  | 011312790A       | 011312790C    |
| 152mm                 | 011315290  | 011315290A       | 011315290C    |

| STAINLESS STEEL MILK BENDS |             |       |            |                 |            |            |
|----------------------------|-------------|-------|------------|-----------------|------------|------------|
|                            | OD          | CLR   | WALL GAUGE | STRAIGHT LENGTH | LENGTH (A) | LENGTH (B) |
| <b>45 Degree</b>           |             |       |            |                 |            |            |
| SSMB.025X45                | 25.4mm 1"   | 51mm  | 1.2mm      | 125mm           | 151mm      | 151mm      |
| SSMB.032X45                | 31.75mm 1¼" | 57mm  | 1.2mm      | 125mm           | 155mm      | 155mm      |
| SSMB.038X45                | 38.1mm 1½"  | 76mm  | 1.2mm      | 125mm           | 164mm      | 164mm      |
| SSMB.051X45                | 50.8mm 2"   | 95mm  | 1.2mm      | 125mm           | 175mm      | 175mm      |
| SSMB.063X45                | 63.5mm 2½"  | 95mm  | 1.2mm      | 125mm           | 178mm      | 178mm      |
| SSMB.076X45                | 76.2mm 3"   | 114mm | 1.6mm      | 125mm           | 189mm      | 189mm      |
| SSMB.102X45                | 101.6mm 4"  | 152mm | 1.6mm      | 150mm           | 235mm      | 235mm      |
| <b>90 Degree</b>           |             |       |            |                 |            |            |
| SSMB.025X90                | 25.4mm 1"   | 51mm  | 1.2mm      | 125mm           | 189mm      | 189mm      |
| SSMB.032X90                | 31.75mm 1¼" | 57mm  | 1.2mm      | 125mm           | 198mm      | 198mm      |
| SSMB.038X90                | 38.1mm 1½"  | 76mm  | 1.2mm      | 125mm           | 220mm      | 220mm      |
| SSMB.051X90                | 50.8mm 2"   | 95mm  | 1.2mm      | 125mm           | 245mm      | 245mm      |
| SSMB.063X90                | 63.5mm 2½"  | 95mm  | 1.2mm      | 125mm           | 252mm      | 252mm      |
| SSMB.076X90                | 76.2mm 3"   | 114mm | 1.6mm      | 125mm           | 277mm      | 277mm      |
| SSMB.102X90                | 101.6mm 4"  | 152mm | 1.6mm      | 150mm           | 353mm      | 353mm      |
| <b>Long Bend</b>           |             |       |            |                 |            |            |
| SSMB.025X90LT              | 25.4mm 1"   | 51mm  | 1.2mm      | 100mm           | 165mm      | 514mm      |
| SSMB.032X90LT              | 31.75mm 1¼" | 57mm  | 1.2mm      | 100mm           | 173mm      | 530mm      |
| SSMB.038X90LT              | 38.1mm 1½"  | 76mm  | 1.2mm      | 100mm           | 195mm      | 552mm      |
| SSMB.051X90LT              | 50.8mm 2"   | 95mm  | 1.2mm      | 100mm           | 221mm      | 578mm      |
| SSMB.063X90LT              | 63.5mm 2½"  | 95mm  | 1.2mm      | 100mm           | 227mm      | 584mm      |
| SSMB.076X90LT              | 76.2mm 3"   | 114mm | 1.6mm      | 100mm           | 252mm      | 609mm      |
| SSMB.102X90LT              | 101.6mm 4"  | 152mm | 1.6mm      | 100mm           | 303mm      | 660mm      |



## Flame proof tanker kits

- > Our **Flame Proof Tanker Kits** are designed to conform to Australian Standard AS2809.1 and AS2809.2.
- > A Standard Kit consists of:
  - Stainless steel top & bottom shroud
  - Stainless steel transition cap (1 large, 1 small)
  - Bracket mounting rings (2)
  - Muffler pipe mounting brackets (2)
  - Chrome plated straight stack
  - Chrome plated silent raincap

*Muffler must be ordered separately if required.*

- > Can be ordered with a deflector instead of straight stack and raincap.

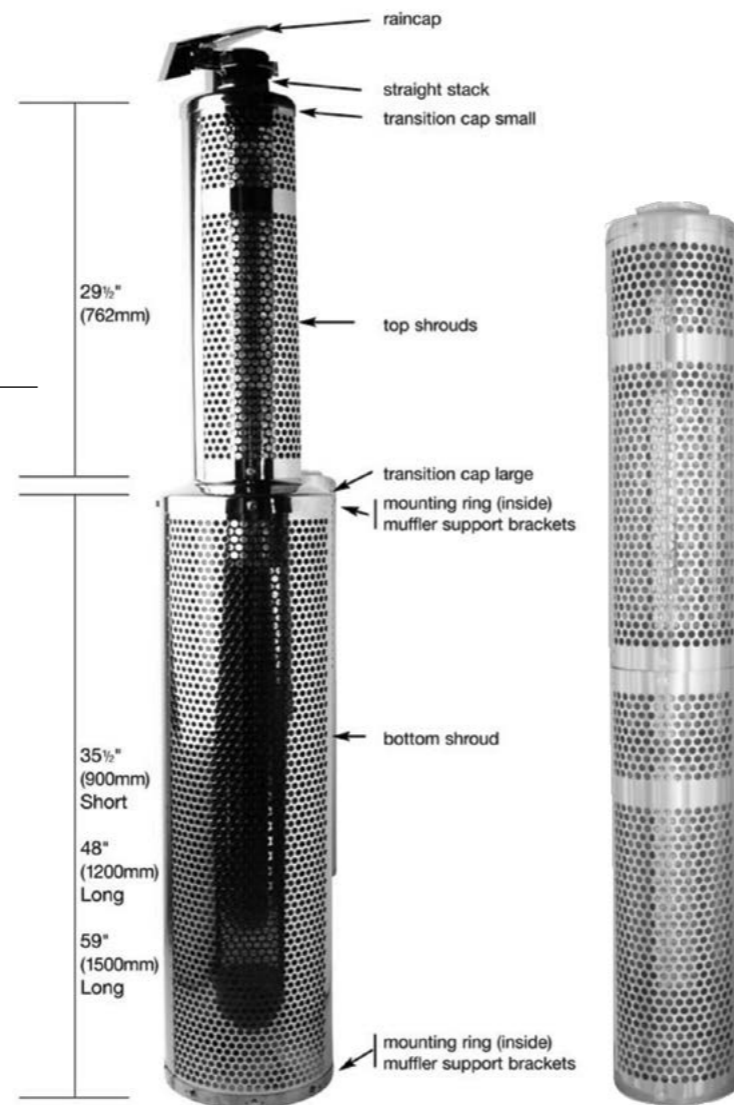

## Pipe shrouds

- > Our **Pipe Shrouds** are supplied in a 'kit' form.
- > The **Short Kit** consists of:
  - one transition cap
  - two shrouds
  - one connect ring
  - one mounting ring / bracket
  - one set of pipe support brackets
- > The **Long Kit** consists of:
  - one transition cap
  - three shrouds
  - two connect rings
  - one mounting ring / bracket
  - three sets of pipe support brackets
- > **Top Shrouds** have an unperforated band near one end. This allows shortening of the shroud by 200mm if required for your application.
- > **Shrouds** listed are supplied without transition caps, mounting rings or support brackets.
  - These must be ordered separately if required.
  - Shrouds will be assembled for transport if requested.
- > **Tanker Kit Exhaust Stacks** are 1 metre long to allow for extra clearance for a raincap to fully open without touching the top transition cap.
  - Longer stacks or deflectors can be used if required.
- > **Pipe Shroud Connect Rings** joins pipe shroud sections in pipe shroud kits.
- > Full guard mounting rings.

| FLAME PROOF TANKER KITS |        |                              |
|-------------------------|--------|------------------------------|
| EXHAUST SIZE            |        | POLISHED STAINLESS STEEL     |
| 76mm                    | 3"     | 0134076T Short bottom shroud |
| 89mm                    | 3 1/2" | 0134089T                     |
| 102mm                   | 4"     | 0134102T                     |
| 114mm                   | 4 1/2" | 0134114T                     |
| 127mm                   | 5"     | 0134127T                     |
| 127mm                   | 5"     | TK127-D (Deflector)          |
| 127mm                   | 5"     | TK127LV (Volvo) 1500mm       |
| 152mm                   | 6"     | 0134152T                     |

| TANKER KIT EXHAUST STACKS |                          |
|---------------------------|--------------------------|
| TUBE OD X LENGTH          | CHROME PLATED MILD STEEL |
| 76 x 1000mm               | CPS076X1000P             |
| 102 x 1000mm              | CPS102X1000P             |
| 114 x 1000mm              | CPS114X1000P             |
| 127 x 1000mm              | CPS127X1000P             |
| 152 x 1000mm              | CPS152X1000P             |

| PIPE SHROUD KITS |                    |              |                          |
|------------------|--------------------|--------------|--------------------------|
| SHORT            |                    | LONG         |                          |
| SUIT PIPE OD     | DIAM. X O/A LENGTH |              | POLISHED STAINLESS STEEL |
| 76mm             | 3"                 | 203 x 1540mm | 0134TSS076               |
| 102mm            | 4"                 | 203 x 1540mm | 0134TSS102               |
| 114mm            | 4 1/2"             | 229 x 1540mm | 0134TSS114               |
| 127mm            | 5"                 | 229 x 1540mm | 0134TSS127               |

| TRANSITION CAPS |         |                 |               |         |                 |
|-----------------|---------|-----------------|---------------|---------|-----------------|
| SMALL           |         |                 | LARGE         |         |                 |
| SUIT KIT SIZE   | OD X ID | STAINLESS STEEL | SUIT KIT SIZE | OD X ID | STAINLESS STEEL |
| 76mm            | 3"      | 203 x 76mm      | 76mm          | 3"      | 305 x 203mm     |
| 89mm            | 3 1/2"  | 203 x 102mm     | 89mm          | 3 1/2"  | 356 x 203mm     |
| 102mm           | 4"      | 203 x 102mm     | 102mm         | 4"      | 356 x 203mm     |
| 114mm           | 4 1/2"  | 229 x 114mm     | 114mm         | 4 1/2"  | 356 x 229mm     |
| 127mm           | 5"      | 229 x 127mm     | 127mm         | 5"      | 356 x 229mm     |
| 152mm           | 6"      | 254 x 152mm     | 152mm         | 6"      | 381 x 254mm     |

| SHROUDS       |                |                 |               |                |                            |
|---------------|----------------|-----------------|---------------|----------------|----------------------------|
| TOP           |                |                 | BOTTOM        |                |                            |
| SUIT KIT SIZE | TRANSITION CAP | STAINLESS STEEL | SUIT KIT SIZE | TRANSITION CAP | STAINLESS STEEL            |
| 76mm          | 3"             | no t/cap        | 76mm          | 3"             | no t/cap                   |
| 76mm          | 3"             | with t/cap      | 89mm          | 3 1/2"         | no t/cap                   |
| 89mm          | 3 1/2"         | no t/cap        | 102mm         | 4"             | no t/cap                   |
| 102mm         | 4"             | no t/cap        | 102mm         | 4"             | with t/cap + mounting ring |
| 102mm         | 4"             | with t/cap      | 114mm         | 4 1/2"         | no t/cap                   |
| 114mm         | 4 1/2"         | no t/cap        | 114mm         | 4 1/2"         | with t/cap + mounting ring |
| 114mm         | 4 1/2"         | with t/cap      | 127mm         | 5"             | no t/cap                   |
| 127mm         | 5"             | no t/cap        | 127mm         | 5"             | with t/cap + mounting ring |
| 127mm         | 5"             | with t/cap      | 127mm         | 5"             | 1500mm                     |
| 152mm         | 6"             | no t/cap        | 152mm         | 6"             | no t/cap                   |
| 152mm         | 6"             | with t/cap      | 152mm         | 6"             | with t/cap + mounting ring |

| MUFFLER SUPPORT BRACKETS |               |             |            |
|--------------------------|---------------|-------------|------------|
| SUIT KIT SIZE            | PIPE x SHROUD | ZINC PLATED |            |
| 76mm                     | 3"            | 76 x 305mm  | 0134GB076E |
| 89mm                     | 3 1/2"        | 89 x 356mm  | 0134GB089F |
| 102mm                    | 4"            | 102 x 356mm | 0134GB102F |
| 114mm                    | 4 1/2"        | 114 x 229mm | 0134GB114D |
| 114mm                    | 4 1/2"        | 114 x 356mm | 0134GB114F |
| 127mm                    | 5"            | 127 x 229mm | 0134GB127D |
| 127mm                    | 5"            | 127 x 356mm | 0134GB127F |
| 152mm                    | 6"            | 152 x 381mm | 0134GB152F |

| PIPE SHROUD CONNECT RINGS |                     |             |       |
|---------------------------|---------------------|-------------|-------|
| SUIT KIT SIZE             | GUARD DIAMETER (OD) | ZINC PLATED |       |
| 76/102mm                  | 3 3/4"              | 203mm       | PSR08 |
| 114/127mm                 | 4 1/2"/5"           | 229mm       | PSR09 |



Mufflers are available in 3 different styles:

- > HEAVY DUTY
- > UNIVERSAL REACTIVE
- > MID RANGE

• Manufactured in Australia.

## Muffler style chart

### EXTERNAL CONFIGURATION

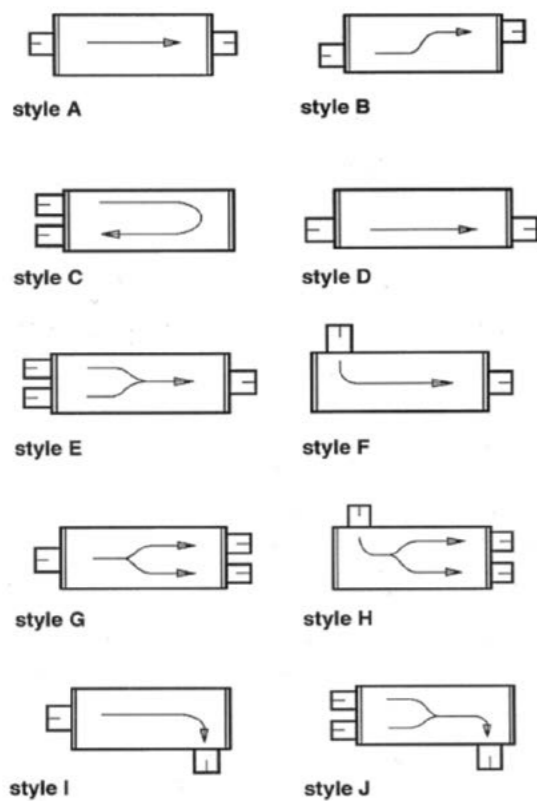

### INTERNAL CONFIGURATION

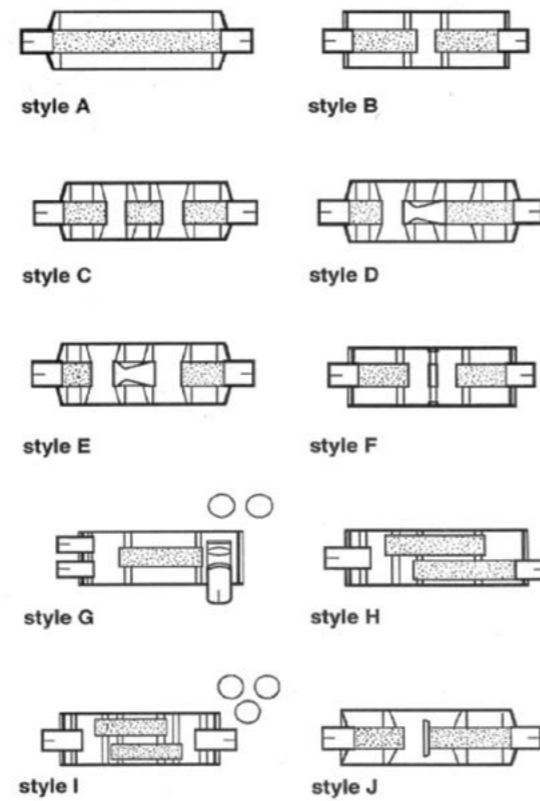

• These diagrams represent many of the common external and internal configurations possible for mufflers.

### MUFFLER - HEAVY DUTY

| PART NUMBER              | INLET ID    | BODY SIZE | BODY LENGTH | STYLE Ext/Int |
|--------------------------|-------------|-----------|-------------|---------------|
| <b>FIBREGLASS PACKED</b> |             |           |             |               |
| M1044-400RA-2            | 102mm (4")  | 254 x     | 1130mm      | AD            |
| M1044-450RA              | 114mm (4½") | 254 x     | 1130mm      | AE            |
| M1044-500RA-2            | 127mm (5")  | 254 x     | 1130mm      | -             |
| M844-500RA-3             | 127mm (5")  | 203 x     | 1130mm      | -             |
| 86786M (Single)          | 127mm (5")  | 254 x     | 1130mm      | AD            |
| 86791M (Dual)            | 127mm (5")  | 254 x     | 1130mm      | AD            |
| <b>REACTIVE</b>          |             |           |             |               |
| M1044-400R               | 102mm (4")  | 254 x     | 1130mm      | AC            |
| M1044-500R               | 127mm (5")  | 254 x     | 1130mm      | AC            |

### MUFFLER - UNIVERSAL REACTIVE

| PART NUMBER | INLET ID   | BODY SIZE | BODY LENGTH | STYLE Ext/Int |
|-------------|------------|-----------|-------------|---------------|
| M830-300R   | 76mm (3")  | 203 x     | 762mm       | AC            |
| M830-300R-1 | 76mm (3")  | 203 x     | 762mm       | AJ            |
| M832-300R ▲ | 76mm (3")  | 203 x     | 817mm       | AC            |
| M836-500R   | 127mm (5") | 203 x     | 914mm       | AC            |
| M838-250R   | 63mm (2½") | 203 x     | 965mm       | AC            |
| M838-300R   | 76mm (3")  | 203 x     | 965mm       | AC            |
| M838-350R   | 89mm (3½") | 203 x     | 965mm       | AC            |
| M934-400R   | 102mm (4") | 229 x     | 864mm       | AC            |
| M936-400R   | 102mm (4") | 229 x     | 914mm       | AC            |
| M936-500A   | 127mm (5") | 229 x     | 914mm       | AC            |
| M936-500R   | 127mm (5") | 229 x     | 914mm       | AC            |
| M940-400R   | 102mm (4") | 229 x     | 1016mm      | AC            |
| M944-350R   | 89mm (3½") | 229 x     | 1130mm      | AC            |
| M944-400R ▲ | 102mm (4") | 229 x     | 1130mm      | AC            |
| M944-500R ▲ | 127mm (5") | 229 x     | 1130mm      | AC            |

### MUFFLER - MID RANGE

| PART NUMBER              | INLET ID   | BODY SIZE | BODY LENGTH | STYLE Ext/Int |
|--------------------------|------------|-----------|-------------|---------------|
| <b>FIBREGLASS PACKED</b> |            |           |             |               |
| M540-250A                | 63mm (2½") | 127 x     | 1016mm      | -             |
| M624-200A                | 51mm (2")  | 152 x     | 610mm       | AB            |
| M624-225A                | 57mm (2¼") | 152 x     | 610mm       | AB            |
| M624-250A                | 63mm (2½") | 152 x     | 610mm       | AB            |
| M624-300A                | 76mm (3")  | 152 x     | 610mm       | AB            |
| M624-350A                | 89mm (3½") | 152 x     | 610mm       | AB            |
| M630-225A                | 57mm (2¼") | 152 x     | 760mm       | AB            |
| M630-250A                | 63mm (2½") | 152 x     | 760mm       | AB            |
| M630-300A                | 76mm (3")  | 152 x     | 760mm       | AB            |
| M630-350A                | 89mm (3½") | 152 x     | 760mm       | AB            |
| M636-300A                | 76mm (3")  | 152 x     | 914mm       | AB            |
| M724-225A                | 57mm (2¼") | 178 x     | 610mm       | AB            |
| M724-250A                | 63mm (2½") | 178 x     | 610mm       | AB            |
| M724-300A                | 76mm (3")  | 178 x     | 610mm       | AB            |
| M724-350A                | 89mm (3½") | 178 x     | 610mm       | AB            |
| M730-250A                | 63mm (2½") | 178 x     | 762mm       | AB            |
| M730-300A                | 76mm (3")  | 178 x     | 760mm       | AB            |
| M730-350A                | 89mm (3½") | 178 x     | 760mm       | AB            |

▲ These Mufflers fit Tanker Kits.



## Nelson Global Products Australia muffler features

### Nelson Global Products Australia OEM Mufflers.

- > OEM models reduce exhaust noise to the level required to meet EPA truck noise limits and the State of Victoria Regulations.
- > OEM models can be quieter (more than 3 dBA) than economy versions, depending on make of engine.
- > OEM models are covered by Nelson Global Products Australia's 4-year warranty.
- > See page 36-41.

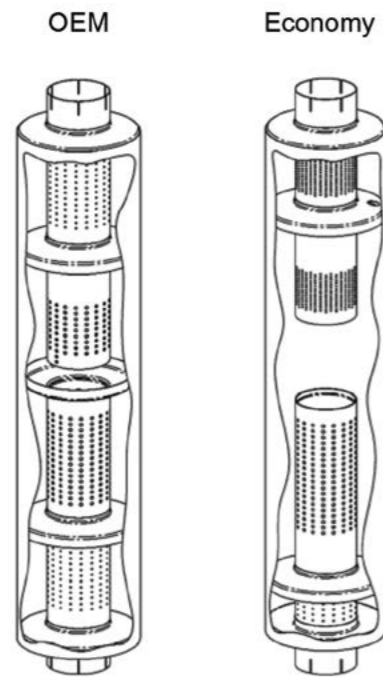

### Nelson Global Products Australia ECONOMY

- > Economy has 16-gauge end flange. (Some competitors are lighter.)
- > Economy includes an internal support flange. (Some competitors do not.)
- > Economy mufflers are covered by Nelson Global Products Australia's 1-year warranty.
- > See page 36-37 for our Economy Range.

## All aluminised steel construction



710°C

**ALUMINISED STEEL** holds its strength characteristics up to 710°C. ALUMINISED STEEL also resists oxidation much longer than unprotected MILD STEEL.

430°C

**Unprotected MILD STEEL** used by many will-fit companies begins to rust as soon as it is exposed to everyday field conditions, regardless of its thickness. This type of MILD STEEL also loses its strength after exposure to minimum exhaust temperatures.

430°C

**GALVANISED STEEL** begins to give off extremely toxic fumes at the minimum 430°C, and immediately loses its rust resistant characteristics.

## Exhaust service tips

- > Use "Wide-Band" style clamps instead of U-Bolt style clamps when installing replacement components. The resulting joint will be leak tight and more easily serviceable on future jobs. "Wide-Band" clamps provide the user full wrap around installation, no pipe distortion when sealing and minimises exhaust leaks and eliminates the need for welding.
- > Eliminate the exhaust system as a source of cab noise by isolating pipe and mufflers with flexible hangers and brackets. On installations where isolation mounts are not practical, use double wrapped mufflers.
- > Exhaust gases are passed through the muffler to reduce the noise of engine combustion. At the same time, back pressure causes exhaust gases to remain in the engine cylinder after the exhaust stroke. And, while a certain amount of backpressure is vital to optimal performance, too much can result in loss of horsepower and excessive engine / turbo charger operating temperatures. When this occurs, performance and fuel economy can suffer.
- > Remember to always replace components with like components in the exhaust system. By replacing an exhaust system part with a like component, you can be assured of the most efficient performance on your engine.
- > Contact our Customer Assistance team for any exhaust queries that you have on **1800 809 914 (Australia)**.

## Reducing noise levels

There are five major sources that contribute to the noise level of a highway.

1. Fan Noise – Excessive fan speed is the biggest noise source in this area. This can be controlled by the use of a temperature controlled or thermostatic fan. Other noise concerns are bent fan blades and broken or missing shrouds.
2. Air Intake – Both the type of system and the location of the inlet affect the truck noise level. Air inlets that open to the side are generally noisier than those that do not.
3. Mechanical Noise – The engine and drive train are the major source of noise. Operating speed, type of engine and drive train all affect the total noise level. Shielding the exposed areas with acoustic barriers will reduce noise levels. Generally, any part of the engine or drive train that can be seen while standing away from the truck will contribute toward the total vehicle noise level.
4. Tyres – Many times this is the major noise source at high speeds. The condition of the tyres and the tread pattern affect the noise level. At low speeds this is not a large noise source.
5. Exhaust System – Worn or inadequate exhaust systems are the largest and the most frequent contributor to high noise levels. A visual inspection and repair of leaking connections or replacement of failed components will noticeably reduce noise levels. If the noise level is still too high, the addition of resonators, packed stacks or a change in mufflers is recommended. The muffler application and performance section of this catalog will give you the recommended mufflers for your particular engine and system configuration.

### SPECIFIC WAYS TO REDUCE EXHAUST NOISE LEVELS

1. Worn or leaking flexible tubing is a common noise source. Replace the part if necessary. The service life of flexible tubing can be improved if it is installed in a relaxed position. Bending, stretching and compressing all reduce life because they limit the tubing's ability to "flex".
2. The entire exhaust system should be well supported. This will reduce the noise generated by the exhaust pipes and the muffler shell. Care must be taken to isolate engine vibration from the exhaust system and to provide for expansion when the system is hot.
3. The addition of an universal resonator in the system will generally reduce the exhaust noise level from 3 to 6 dBA. Packed stacks would reduce the noise level 3 to 4 dBA. Both items have a minimal effect on engine backpressure.
4. Change from a single to a dual system. For maximum benefit, special "dual only" mufflers are usually recommended. Lower system backpressure is generally an additional benefit of dual systems.
5. On horizontal systems, the tail spouts should be pointed towards the center of the roadway. This reduces the noise reflected off the road surface and perceived by kerbside observers to be quieter.
6. On vertical systems, straight stacks will yield lower sound levels than will curved stacks. Straight stacks direct the noise upward, where curved stacks direct noise towards the observer.

### AUSTRALIAN STANDARD EXHAUST NOISE REGULATION ADR 28/01

| EXHAUST NOISE LEVEL IN dBA   |    |    |  |    |    |   |    |    |  |
|--|----|----|--|----|----|---|----|----|--|
| Excellent  |    |    | Good   |    |    | Marginal  |    |    |  |
| 66   | 68 | 70 | 72   | 74 | 76 | 78  | 80 | 82 |  |
| Muffler noise levels less than 70 will allow almost any truck to meet Australian Design Rule 28/01 for External Noise of Motor Vehicles. The only exception is a vehicle with several other excessive noise sources. |    |    | Muffler noise levels between 70 and 74 dBA would enable a vehicle to meet Australian Design Rule 28/01 for External Noise of Motor Vehicles if other noise sources are normal. |    |    | Muffler noise levels of 75 dBA and above. Australian Standard ADR 28/01. Total noise levels 78 to 87 depending on vehicle type and power. Measured at 25 ft (7.5m) in a moving vehicle. |    |    |  |

### US FEDERAL NOISE ACT 1978

| EXHAUST NOISE LEVEL IN dBA  |    |    |  |    |    |  |    |    |  |
|---|----|----|--|----|----|--|----|----|--|
| Excellent   |    |    | Good   |    |    | Marginal   |    |    |  |
| 66  | 68 | 70 | 72   | 74 | 76 | 78   | 80 | 82 |  |
| Exhaust noise levels less than 73 will allow almost any truck to meet an 83 dBA level. The only exception is a vehicle with several other excessive noise sources.  |    |    | Exhaust noise levels between 73 and 78 dBA would enable a vehicle to meet an 83 dBA level if the other noise sources are normal. |    |    | Exhaust noise levels of 78 dBA or higher generally will not allow a truck to have a total vehicle noise of 83 dBA unless all other noise sources are controlled. |    |    |  |
| To reduce the vehicle noise level to 80 dBA, the categories on the chart must be reduced 4 dBA. Excellent would be less than 69 to 74 dBA and marginal would be 74 and above. Measured at 50 ft moving, must be <85dBA. |    |    |  |    |    |  |    |    |  |

# MUFFLERS

## TYPE 1

# MUFFLERS

## TYPE 1

### End in / opposite end out – both on centre

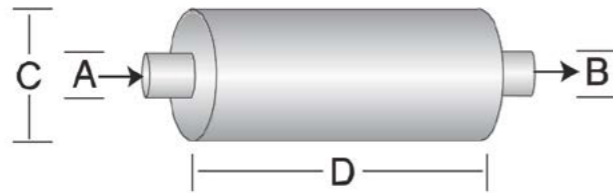

| PART NUMBER      | INLET ID   |            | OUTLET ID       |        | BODY SIZE | BODY LENGTH | MAX FLOW  |       | NOTES |
|------------------|------------|------------|-----------------|--------|-----------|-------------|-----------|-------|-------|
|                  | A          | B          | C               | D      |           |             | 3" Hg     | 2" Hg |       |
| <b>Round</b>     |            |            |                 |        |           |             |           |       |       |
| 86177M           | 51mm (2")  | 51mm (2")  | 107mm           | 323mm  | 400       | 300         | ID/OD     |       |       |
| 86186M           | 64mm (2½") | 64mm (2½") | 150mm           | 533mm  | 860       | 715         | ID/ID     |       |       |
| 10156T           | 74mm (2⅞") | 79mm (3⅓") | 142mm           | 516mm  | 675       | 550         | ID/OD     |       |       |
| 20153T           | 76mm (3")  | 79mm (3⅓") | 206mm           | 310mm  | 750       | 600         | ID/OD     |       |       |
| 86187M           | 76mm (3")  | 76mm (3")  | 155mm           | 533mm  | 1100      | 920         | ID/ID     |       |       |
| 86690M           | 81mm (3⅓") | 81mm (3⅓") | 257mm           | 580mm  | 1000      | 815         | ID/ID     |       |       |
| 10019T           | 84mm (3⅔") | 89mm (3½") | 168mm           | 514mm  | 1050      | 860         | ID/OD     |       |       |
| 86188M           | 89mm (3½") | 89mm (3½") | 180mm           | 762mm  | 1450      | 1200        | ID/ID     |       |       |
| 86113M           | 89mm (3½") | 89mm (3½") | 229mm           | 1130mm | 1200      | 1000        | ID/ID     |       |       |
| 11325T           | 99mm (3⅞") | 91mm (3⅝") | 117mm           | 213mm  | 1125      | 920         | Flared/ID |       |       |
| 86189M           | 102mm (4") | 102mm (4") | 180mm           | 711mm  | 2100      | 1750        | ID/ID     |       |       |
| 86127M           | 102mm (4") | 102mm (4") | 216mm           | 874mm  | 2000      | 1670        | ID/ID     |       |       |
| 86131M           | 102mm (4") | 102mm (4") | 229mm           | 1130mm | 2000      | 1670        | ID/ID     |       |       |
| 86108M           | 102mm (4") | 102mm (4") | 229mm           | 1130mm | 1600      | 1350        | ID/ID     |       |       |
| 86740M (Economy) | 102mm (4") | 127mm (5") | 229mm           | 1130mm | 1900      | 1500        | ID/ID     |       |       |
| 86560M           | 102mm (4") | 102mm (4") | 229mm           | 508mm  | 2000      | 1670        | ID/ID     |       |       |
| 86561M           | 102mm (4") | 102mm (4") | 229mm           | 711mm  | 1875      | 1580        | ID/ID     |       |       |
| 86544M           | 102mm (4") | 102mm (4") | 257mm           | 1130mm | 1600      | 1350        | ID/ID     |       |       |
| 86713M (Economy) | 102mm (4") | 102mm (4") | 229mm           | 1130mm | 1750      | 1450        | I/OD      |       |       |
| 86102M           | 127mm (5") | 127mm (5") | 229mm           | 1130mm | 2160      | 1800        | ID/ID     |       |       |
| 86132M           | 127mm (5") | 127mm (5") | 229mm           | 1130mm | 3600      | 3000        | ID/ID     |       |       |
| 86624M           | 127mm (5") | 127mm (5") | 229mm           | 851mm  | 2160      | 1800        | ID/ID     |       |       |
| 86739M (Economy) | 127mm (5") | 127mm (5") | 229mm           | 1130mm | 2850      | 2400        | ID/ID     |       |       |
| 86130M           | 127mm (5") | 127mm (5") | 257mm           | 1130mm | 2300      | 1920        | ID/ID     |       |       |
| 86195M           | 127mm (5") | 127mm (5") | 257mm           | 1130mm | 2800      | 2330        | ID/ID     |       |       |
| 86531M           | 127mm (5") | 127mm (5") | 257mm           | 1130mm | 2800      | 2330        | ID/ID     |       |       |
| 86656M           | 127mm (5") | 152mm (6") | 257mm           | 1130mm | 3400      | 2775        | ID/ID     |       |       |
| 86682M (Economy) | 127mm (5") | 127mm (5") | 257mm           | 1130mm | 2850      | 2400        | ID/ID     |       |       |
| 86786M (Single)  | 127mm (5") | 127mm (5") | 257mm           | 1130mm | –         | –           | ID/ID     |       |       |
| 86791M (Dual)    | 127mm (5") | 127mm (5") | 257mm           | 1130mm | –         | –           | ID/ID     |       |       |
| 86610M           | 152mm (6") | 152mm (6") | 282mm           | 1130mm | 3700      | 3020        |           |       |       |
| <b>Oval</b>      |            |            |                 |        |           |             |           |       |       |
| 19383T           | 53mm (2⅓") | 57mm (2¼") | (117 x 213mm) x | 508mm  | 415       | 340         | ID/OD     |       |       |
| 20680T           | 64mm (2½") | 64mm (2½") | (117 x 213mm) x | 457mm  | 460       | 380         | ID/OD     |       |       |

### Resonator – type 1

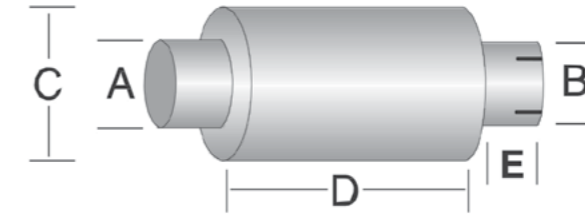

| PART NUMBER | INLET ID |       | OUTLET ID |       | BODY SIZE | BODY LENGTH | INLET LENGTH |
|-------------|----------|-------|-----------|-------|-----------|-------------|--------------|
|             | A        | B     | C         | D     |           |             |              |
| 86144M      | 102mm    | 102mm | 229mm     | 292mm | 64mm      |             |              |
| 86145M      | 127mm    | 127mm | 229mm     | 292mm | 64mm      |             |              |



# MUFFLERS

## TYPE 2

# MUFFLERS

## TYPE 3

### Type 2 - end in / opposite end out – both offset

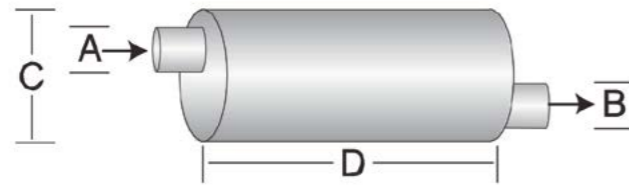

| PART NUMBER  | INLET ID                               |  | OUTLET ID       |       | BODY SIZE<br>C | BODY LENGTH<br>D | MAX FLOW         |  | NOTES |
|--------------|--|--|-----------------|-------|----------------|------------------|------------------|--|-------|
|              | A                                      | B                                      | 3" Hg           | 2" Hg |                |                  |                  |  |       |
| <b>Round</b> |  |  |                 |       |                |                  |                  |  |       |
| 86136M       | 51mm (2")                              | 51mm (2")                              | 155mm           | 610mm | 500            | 420              | ID/ID            |  |       |
| 02366T       | 61mm (2 <sup>2</sup> / <sub>5</sub> ") | 46mm (1 <sup>4</sup> / <sub>5</sub> ") | 168mm           | 152mm | 260            | 215              | ID/OD            |  |       |
| 10163T       | 64mm (2 <sup>1</sup> / <sub>2</sub> ") | 64mm (2 <sup>1</sup> / <sub>2</sub> ") | 168mm           | 711mm | 660            | 530              | - ID/ID          |  |       |
| 86137M       | 64mm (2 <sup>1</sup> / <sub>2</sub> ") | 64mm (2 <sup>1</sup> / <sub>2</sub> ") | 168mm           | 711mm | 800            | 670              | ID/ID            |  |       |
| 86594M       | 64mm (2 <sup>1</sup> / <sub>2</sub> ") | 64mm (2 <sup>1</sup> / <sub>2</sub> ") | 213mm           | 706mm | 510            | 420              | ID*2/OD          |  |       |
| 86139M       | 76mm (3")                              | 76mm (3")                              | 216mm           | 792mm | 1150           | 960              | ID/ID Heavy duty |  |       |
| 86119M       | 76mm (3")                              | 76mm (3")                              | 216mm           | 706mm | 1000           | 835              | ID/ID            |  |       |
| 86168M       | 102mm (4")                             | 102mm (4")                             | 267mm           | 851mm | 1650           | 1375             |                  |  |       |
| <b>Oval</b>  |  |  |                 |       |                |                  |                  |  |       |
| 86179M       | 102mm (4")                             | 102mm (4")                             | (211 x 292mm) x | 686mm | 1150           | 760              | ID/ID            |  |       |
| 86661M       | 102mm (4")                             | 102mm (4")                             | (211 x 292mm) x | 686mm | 1150           | 690              | ID/ID HD86179M   |  |       |
| 86125M       | 102mm (4")                             | 102mm (4")                             | (254 x 381mm) x | 660mm | 1750           | 1460             | ID/ID            |  |       |
| 86147M       | 127mm (5")                             | 127mm (5")                             | (254 x 381mm) x | 660mm | 2950           | 2500             | ID/ID            |  |       |
| 86117M       | 127mm (5")                             | 127mm (5")                             | (254 x 381mm) x | 914mm | 2600           | 2170             | ID/ID            |  |       |
| 86180M       | 152mm (6")                             | 152mm (6")                             | (254 x 381mm) x | 805mm | 3800           | 3170             | ID/ID            |  |       |

\* Cubic Feet per Minute

### Type 3 – end in / end out – same end

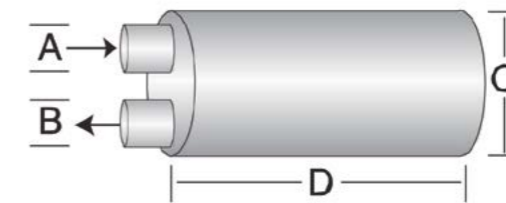

| PART NUMBER  | INLET ID   |            | OUTLET ID       |       | BODY SIZE<br>C | BODY LENGTH<br>D | MAX FLOW |  | NOTES |
|--------------|------------|------------|-----------------|-------|----------------|------------------|----------|--|-------|
|              | A          | B          | 3" Hg           | 2" Hg |                |                  |          |  |       |
| <b>Round</b> |            |            |                 |       |                |                  |          |  |       |
| 86133M       | 102mm (4") | 102mm (4") | 257mm           | 711mm | 1700           | 1420             | ID/ID    |  |       |
| <b>Oval</b>  |            |            |                 |       |                |                  |          |  |       |
| 86121M       | 128mm (5") | 127mm (5") | (254 x 381mm) x | 660mm | 2200           | 1850             | ID/ID    |  |       |

# MUFFLERS

## TYPE 5\* AND 7\*

# MUFFLERS

## TYPE 10

### Type 5\* – side in / end out

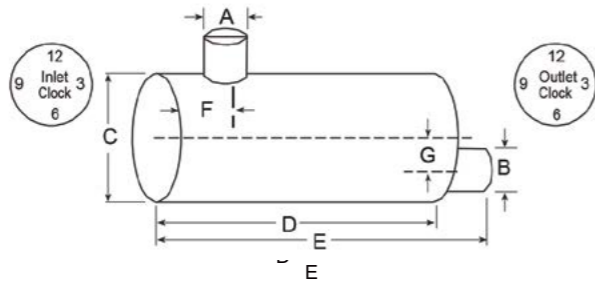

| Part Number | A<br>Inlet I.D.<br>inch/mm | B<br>Outlet I.D.<br>inch/mm | C<br>Body Size<br>inch/mm  | D<br>Body Length<br>inch/mm | E<br>Overall Length<br>inch/mm | F<br>Inlet Offset<br>inch/mm | G<br>Outlet Offset<br>inch/mm | Inlet Clock Position | Outlet Clock Position | Max. Flow Rate |        |
|-------------|----------------------------|-----------------------------|----------------------------|-----------------------------|--------------------------------|------------------------------|-------------------------------|----------------------|-----------------------|----------------|--------|
|             |                            |                             |                            |                             |                                |                              |                               |                      |                       | @3" Hg         | @2" Hg |
| 86191M      | 2.5<br>(63.5)              | 2.5<br>(63.5)               | 6.6<br>(167.6)             | 20.8<br>(528.3)             | 23.5<br>(596.9)                | 3.5<br>(88.9)                | 1.4<br>(35.6)                 | 6                    | 3                     | 640            | 535    |
| 86192M      | 3.0<br>(76.2)              | 3.0<br>(76.2)               | 8.5<br>(215.9)             | 27.0<br>(686.8)             | 29.5<br>(749.3)                | 4.5<br>(114.3)               | 2.0<br>(50.8)                 | 6                    | 3                     | 860            | 700    |
| 13900T      | 3.1<br>(78.7)              | 3.0<br>(76.2)O.D.           | 10.1<br>(256.5)            | 17.3<br>(439.4)             | 24.5<br>(622.3)                | 14.5<br>(368.3)              | 1.9<br>(48.3)                 | 6                    | 12                    | 695            | 565    |
| 86194M      | 5.0<br>(127.0)             | 5.0<br>(127.0)              | 10.5x15.0<br>(254.0x381.0) | 36.0<br>(914.4)             | 40.0<br>(1016.0)               | 6.1<br>(154.9)               | 3.1<br>(78.7)                 | 9                    | 12                    | 2200           | 1850   |
| 86148M      | 4.0<br>(101.6)             | 4.0<br>(101.6)              | 10.1<br>(256.5)            | 28.0<br>(711.2)             | 30.5<br>(774.7)                | 2.4<br>(61.0)                | 7.3<br>(185.4)                | 6                    | 1                     | 1960           | 1600   |

### Type 7\* – end in / side out

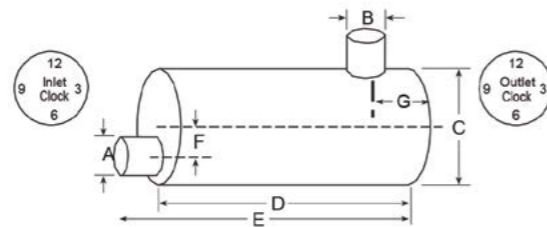

| Part Number | A<br>Inlet I.D.<br>inch/mm | B<br>Outlet I.D.<br>inch/mm | C<br>Body Size<br>inch/mm | D<br>Body Length<br>inch/mm | E<br>Overall Length<br>inch/mm | F<br>Inlet Offset<br>inch/mm | G<br>Outlet Offset<br>inch/mm | Inlet Clock Position | Outlet Clock Position | Max. Flow Rate |        |
|-------------|----------------------------|-----------------------------|---------------------------|-----------------------------|--------------------------------|------------------------------|-------------------------------|----------------------|-----------------------|----------------|--------|
|             |                            |                             |                           |                             |                                |                              |                               |                      |                       | @3" Hg         | @2" Hg |
| 86148M      | 4.0<br>(101.6)             | 4.0<br>(101.6)              | 10.1<br>(256.5)           | 28.0<br>(711.2)             | 30.5<br>(774.7)                | 2.4<br>(61.0)                | 7.3<br>(185.4)                | 6                    | 1                     | 1960           | 1600   |
| 86530M      | 4.0<br>(101.6)             | 4.0<br>(101.6)              | 11.1<br>(281.9)           | 36.0<br>(914.4)             | 39.0<br>(990.6)                | 1.5<br>(38.1)                | 28.5<br>(723.9)               | 6                    | 12                    | 1720           | 1440   |
| 86672M      | 5.0<br>(127.0)             | 5.0<br>(127.0)              | 11.1<br>(281.9)           | 36.0<br>(914.4)             | 39.2<br>(995.7)                | 2.7<br>(68.6)                | 28.5<br>(723.9)               | 6                    | 12                    | 1900           | 1590   |

### Type 10 – end in (female threads) / end out (perforations) cup muffler

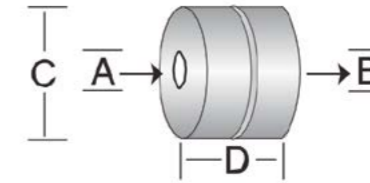

| PART NUMBER  | INLET ID | OUTLET ID    | BODY SIZE  | BODY LENGTH | MAX FLOW |       | NOTES |
|--------------|----------|--------------|------------|-------------|----------|-------|-------|
|              |          |              |            |             | 3" Hg    | 2" Hg |       |
|              |          |              |            |             | *CFM     |       |       |
| <b>Round</b> |          |              |            |             |          |       |       |
| 04790M       | 1" NPT   | Perforations | 81 x 86mm  | 86mm        | **       |       |       |
| 12778M       | 1" NPT   | Perforations | 107 x 84mm | 84mm        | **       |       |       |

NPT = National Pipe Thread.



# FULL AND HALF EXHAUST GUARDS

# FULL AND HALF EXHAUST GUARDS

- > Heat guards are available in polished bright Stainless Steel.
- > Polished bright Stainless Steel will not discolour, crack, chip or peel.
- > Mounting ring included. Guard (sold separately).

Further guards available page 45.  
Manufactured in Australia.



## Guard brackets



- > Zinc plated.
- > Nuts and bolts included.

## Silent raincaps



- > Raincap are available in single units or bulk quantities.
- > Raincaps available in bulk packs at a discounted rate. If ordering in bulk quantities please add -B to the end of the part number. eg: 0171038ES-B

## Full & half guard bracket mounting rings



- > For half guard brackets to suit 152mm and 203mm guards, use 'U' bolts.
- > For half guard brackets to suite 254mm and 305mm guards, refer to Full guard brackets on this page.

| FULL EXHAUST GUARDS              |                 |  |
|----------------------------------|-----------------|--|
| GUARD DIAMETER<br>x GUARD HEIGHT | STAINLESS STEEL |  |
| 152 x 914mm                      | 0134152F        |  |
| 1219mm                           | 0134152FL       |  |
| 203 x 914mm                      | 0134203F        |  |
| 1219mm                           | 0134203FL       |  |
| 1500mm                           | -               |  |
| 254 x 1219mm                     | 0134254F        |  |
| 280 x 1100mm                     | 0134280F        |  |
| 1219mm                           | 0134280FL       |  |
| 305 x 1219mm                     | 0134305F        |  |

Brackets for full & half guards must be ordered separately to match pipe / exhaust size

| GUARD BRACKETS                    |               |  |
|-----------------------------------|---------------|--|
| GUARD DIAMETER<br>x PIPE DIAMETER | ZINC PLATED   |  |
| 152 x 51mm                        | 0134GB152X51  |  |
| 57mm                              | 0134GB152X57  |  |
| 63mm                              | 0134GB152X63  |  |
| 76mm                              | 0134GB152X76  |  |
| 89mm                              | 0134GB152X89  |  |
| 203 x 63mm                        | 0134GB203X63  |  |
| 76mm                              | 0134GB203X76  |  |
| 89mm                              | 0134GB203X89  |  |
| 102mm                             | 0134GB203X102 |  |
| 127mm                             | 0134GB203X127 |  |
| 229 x 127mm                       | 0134GB229X127 |  |
| 254 x 63mm                        | 0134GB254X63  |  |
| 76mm                              | 0134GB254X76  |  |
| 89mm                              | 0134GB254X89  |  |
| 102mm                             | 0134GB254X102 |  |
| 127mm                             | 0134GB254X127 |  |
| 280 x 76mm                        | 0134GB280X76  |  |
| 89mm                              | 0134GB280X89  |  |
| 102mm                             | 0134GB280X102 |  |
| 127mm                             | 0134GB280X127 |  |
| 305 x 76mm                        | 0134GB305X76  |  |
| 89mm                              | 0134GB305X89  |  |
| 102mm                             | 0134GB305X102 |  |
| 127mm                             | 0134GB305X127 |  |
| 152mm                             | 0134GB305X152 |  |

Two brackets are required for each guard (top and bottom).  
Nuts and bolts are supplied with bracket

| FULL GUARD MOUNTING BRACKET RINGS |             |  |
|-----------------------------------|-------------|--|
| SUIT GUARD DIAMETER               | ZINC PLATED |  |
| 152mm                             | FGMR06      |  |
| 203mm                             | FGMR08      |  |
| 229mm                             | FGMR09      |  |
| 254mm                             | FGMR10      |  |
| 280mm                             | FGMR11      |  |
| 305mm                             | FGMR12      |  |
| 356mm                             | FGMR14      |  |

| HALF EXHAUST GUARDS              |                 |  |
|----------------------------------|-----------------|--|
| GUARD DIAMETER<br>x GUARD HEIGHT | STAINLESS STEEL |  |
| 152 x 914mm                      | 0134152H        |  |
| 1219mm                           | 0134152HL       |  |
| 203 x 914mm                      | 0134203H        |  |
| 1219mm                           | 0134203HL       |  |
| 1500mm                           | 0134203HLX      |  |
| 254 x 1219mm                     | 0134254H        |  |
| 280 x 1100mm                     | -               |  |
| 1219mm                           | -               |  |
| 305 x 1219mm                     | 0134305H        |  |

Brackets for full & half guards must be ordered separately to match pipe / exhaust size

| SILENT RAINCAPS - ZINC PLATED |               |         |        |
|-------------------------------|---------------|---------|--------|
| PART NO                       | BULK PACK QTY | SUIT OD |        |
| 0171038ES                     | 60            | 38mm    | 1 1/2" |
| 0171044ES                     | 55            | 44mm    | 1 3/4" |
| 0171051ES                     | 40            | 51mm    | 2"     |
| 0171057ES                     | 35            | 57mm    | 2 1/4" |
| 0171063ES                     | 30            | 63mm    | 2 1/2" |
| 0171070ES                     | 25            | 70mm    | 2 3/4" |
| 0171076ES                     | 25            | 76mm    | 3"     |
| 0171089ES                     | 35            | 89mm    | 3 1/2" |
| 0171102ES                     | 25            | 102mm   | 4"     |
| 0171114ES                     | 20            | 114mm   | 4 1/2" |
| 0171127ES                     | 20            | 127mm   | 5"     |
| 0171140ES                     | -             | 140mm   | 5 1/2" |
| 0171152ES                     | 15            | 152mm   | 6"     |
| 0171203ES                     | -             | 203mm   | 8"     |

\* Raincaps available in single units or bulk.

| SILENT RAINCAPS - CHROME PLATED |               |         |        |
|---------------------------------|---------------|---------|--------|
| PART NO                         | BULK PACK QTY | SUIT OD |        |
| 0171038ESC                      | -             | 38mm    | 1 1/2" |
| 0171044ESC                      | -             | 44mm    | 1 3/4" |
| 0171051ESC                      | -             | 51mm    | 2"     |
| 0171057ESC                      | -             | 57mm    | 2 1/4" |
| 0171063ESC                      | -             | 63mm    | 2 1/2" |
| 0171070ESC                      | -             | 70mm    | 2 3/4" |
| 0171076ESC                      | 25            | 76mm    | 3"     |
| 0171089ESC                      | -             | 89mm    | 3 1/2" |
| 0171102ESC                      | 25            | 102mm   | 4"     |
| 0171114ESC                      | -             | 114mm   | 4 1/2" |
| 0171127ESC                      | 20            | 127mm   | 5"     |
| 0171140ESC                      | -             | 140mm   | 5 1/2" |
| 0171152ESC                      | 15            | 152mm   | 6"     |

| HALF GUARD BRACKET MOUNTING RINGS |             |  |
|-----------------------------------|-------------|--|
| SUIT GUARD DIAMETER               | ZINC PLATED |  |
| 152mm                             | HGR06       |  |
| 203mm                             | HGR08       |  |
| 254mm                             | HGR10       |  |
| 305mm                             | HGR12       |  |

# FULL GUARD AND HALF GUARD WRAPS

# FULL GUARD AND HALF GUARD WRAPS

## Heat shield

Nelson Global Products Australia heat guards are available in:

- > ALUMINISED
- > POLISHED BRIGHT STAINLESS STEEL

- > Polished bright **Stainless Steel** will not discolour, crack, chip or peel.
- > Comes in a protective plastic wrap to prevent scratches whilst being shipped.
- > 180°, 270° and 360° surface coverage available.
  - 180° contains 2 sets of 2 mounting holes.
  - 270° contains 2 sets of 4 mounting holes.
  - 360° contains 2 sets of 4 mounting holes.

Further guards available page 45.

\*Imported

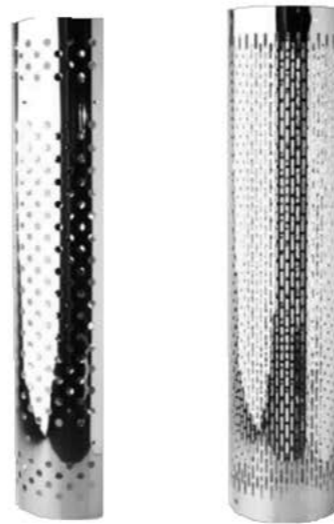

## Clamp kits

- > 2 Chrome plated clamps per Kit.
- > STAINLESS mounting hardware supplied with each kit:
  - 3 standoffs for 1/2 guard wrap
  - 4 standoffs for 3/4 guard wrap



## Handles

Cab Handles available in:

- > POLISHED STAINLESS STEEL

Universal Grab Handle available in:

- > CHROME PLATED



## Full guard bracket kit

- > Can be modified for off-centre tubes.
- > Not visible above shield.
- > Includes 2 complete brackets and all hardware required to mount shield.



### HALF GUARD WRAP ▼ - 1219MM

| TO SUIT MUFFLER DIA. | STYLE           | STAINLESS STEEL |
|----------------------|-----------------|-----------------|
| 102 - 127mm          | 20mm Hole       | 89744C          |
| 152mm                | 20mm Hole       | 90856C          |
| 152mm                | Vertical Slot   | 90976C          |
| 216 - 267mm          | 20mm Hole       | 89747C          |
| 216 - 267mm          | Horizontal Slot | -               |
| 216 - 267mm          | Vertical Slot   | 89745C          |

### 3/4 GUARD WRAP ▼

| MUFFLER DIAMETER | STYLE           | LENGTH | STAINLESS STEEL |
|------------------|-----------------|--------|-----------------|
| 216 - 257mm      | 20mm Hole       | 1219mm | 89749C          |
| 216 - 257mm      | Vertical Slot   | 1219mm | -               |
| 216 - 257mm      | Horizontal Slot | 1219mm | -               |
| 216 - 257mm      | 20mm Hole       | 1295mm | -               |
| 216 - 257mm      | Horizontal Slot | 1295mm | -               |
| 216 - 257mm      | Blank Pattern   | 1295mm | -               |

▼ Guards do not have mounting rings included.

### 1/2 GUARD CLAMP KIT

| CLAMP ID | CLAMP OD | SUIT GUARD | CLAMPS PER KIT | CHROME PLATED |
|----------|----------|------------|----------------|---------------|
| 102mm    | 146mm    | 1/2        | 2              | 89770K        |
| 127mm    | 171mm    | 1/2        | 2              | 89771K        |
| 152mm    | 197mm    | 1/2        | 2              | 90857K        |
| 216mm    | 267mm    | 1/2        | 2              | 89761K        |
| 229mm    | 273mm    | 1/2        | 2              | 89762K        |
| 257mm    | 301mm    | 1/2        | 2              | 89763K        |
| 265mm    | 311mm    | 1/2        | 2              | 89764K        |

### 3/4 GUARD CLAMP KIT

| CLAMP ID | CLAMP OD | SUIT GUARD | CLAMPS PER KIT | CHROME PLATED |
|----------|----------|------------|----------------|---------------|
| -        | -        | -          | -              | -             |
| -        | -        | -          | -              | -             |
| -        | -        | -          | -              | -             |
| -        | -        | -          | -              | -             |
| 229mm    | 273mm    | 3/4        | 2              | 89766K        |
| 257mm    | 301mm    | 3/4        | 2              | 89767K        |
| -        | -        | -          | -              | -             |

### MISCELLANEOUS ACCESSORIES

#### HANDLES

| SIZE       | CAB HANDLE | UNIVERSAL GRAB HANDLE |
|------------|------------|-----------------------|
| 25 x 400mm | 0134H400   | -                     |
| 25 x 550mm | 0134H550   | -                     |
| 600mm      | -          | -                     |

#### FULL GUARD WRAP - BRACKET KIT

| TO FIT TUBE SIZE | CLAMPS PER KIT | PART NUMBER |
|------------------|----------------|-------------|
| 102mm            | 2              | -           |
| 127mm            | 2              | -           |



## Spark arrestors - screen type

- > These Spark Arrestors have a screen element that must be periodically removed (four bolts) and shaken clean to maintain peak performance of the unit. Spare Parts in the form of replacement outlet units are available to order.
- > Screen Type Spark Arrestors and Spark Arrestor Mufflers are manufactured by Nelson Global Products Australia Australia to conform to Australian Standard AS1019.
- > All the Spark Arrestors on this page can be mounted either horizontally or vertically.



## Spark arrestors – cyclonic type

- > **Available in scooped baffle**
- > These Spark Arrestors have a 'drain plug' that must be periodically opened with the engine running to clean out the unit and help maintain peak performance of the unit.
- > Cyclonic Type Scooped Baffle Spark Arrestors are manufactured by Nelson Global Products Australia Australia to conform to Australian Standard AS1019.



## Spark arrestors – USA design

- > Designed for universal application with a minimum of restriction on the engine. They work well as add-on units to existing exhaust systems. Their light weight and small size reduce stress and vibration to the rest of the exhaust system. Typical applications include logging and construction equipment, agricultural machinery, off road trucks, airport equipment, forestry and military vehicles.
- > All arrestors exceed U.S. Forestry requirements, and are qualified and tested for vertical and horizontal installations under the U.S. Forestry Service Standard 5100-1c.
- > All inlets are slotted tube connections. Outlets are OD tubing.
- > CFM rating is based on a pressure drop of 1PSI.



### SPARK ARRESTORS - SCREEN TYPE

| SPARK ARRESTOR   |          |               |             | SPARK ARRESTOR MUFFLERS                       |          |               |             |
|--|----------|---------------|-------------|---|----------|---------------|-------------|
| Up to 53kw (70HP) 2" Outlet – (Overall height 425mm)   |          |               |             | Up to 53kw (70HP) – (Overall height 775mm)    |          |               |             |
| PART NUMBER  | INLET ID | BODY DIAMETER | BODY LENGTH | PART NUMBER                                   | INLET ID | BODY DIAMETER | BODY LENGTH |
| SAA-4138   | 38mm 1½" | 102mm x       | 220mm       | SAMA-4138                                     | 38mm 1½" | 102mm x       | 440mm       |
| SAA-4145   | 45mm 1¾" | 102mm x       | 220mm       | SAMA-4145                                     | 45mm 1¾" | 102mm x       | 440mm       |
| SAA-4151   | 51mm 2"  | 102mm x       | 220mm       | SAMA-4151                                     | 51mm 2"  | 102mm x       | 440mm       |
| SAA-4157   | 57mm 2¼" | 102mm x       | 220mm       | SAMA-4157                                     | 57mm 2¼" | 102mm x       | 440mm       |
| SAA-4163   | 63mm 2½" | 102mm x       | 220mm       | SAMA-4163                                     | 63mm 2½" | 102mm x       | 440mm       |
| Up to 104kw (140HP) 3" Outlet – (Overall height 505mm) |          |               |             | Up to 104kw (140 HP) – (Overall height 925mm) |          |               |             |
| PART NUMBER  | INLET ID | BODY DIAMETER | BODY LENGTH | PART NUMBER                                   | INLET ID | BODY DIAMETER | BODY LENGTH |
| SAA-5151   | 51mm 2"  | 127mm x       | 300mm       | SAMA-5151                                     | 51mm 2"  | 127mm x       | 500mm       |
| SAA-5157   | 57mm 2¼" | 127mm x       | 300mm       | SAMA-5157                                     | 57mm 2¼" | 127mm x       | 500mm       |
| SAA-5163   | 63mm 2½" | 127mm x       | 300mm       | SAMA-5163                                     | 63mm 2½" | 127mm x       | 500mm       |
| SAA-5176   | 76mm 3"  | 127mm x       | 300mm       | SAMA-5176                                     | 76mm 3"  | 127mm x       | 500mm       |

These Spark Arrestors have a screen element that must be periodically removed (four bolts) and shaken clean to maintain peak performance of the unit. Spare Parts in the form of replacement outlet units are available to order.

### SPARK ARRESTORS – CYCLONIC TYPE

| SCOOPED BAFFLE |          |              |        |                |
|----------------|----------|--------------|--------|----------------|
| PART NUMBER    | INLET ID | POWER RATING | MAX kw | OVERALL HEIGHT |
| SATA-51        | 51mm 2"  | 65HP         | 53kw   | 975mm          |
| SATA-57        | 57mm 2¼" | 65HP         | 53kw   | 975mm          |
| SATA-63        | 63mm 2½" | 65HP         | 53kw   | 975mm          |
| SATA-76        | 76mm 3"  | 120HP        | 53kw   | 1025mm         |

### SPARK ARRESTORS – USA DESIGN

| PART No. | ID       | OD        | BODY DIAMETER | BODY LENGTH | OVERALL LENGTH | INLET LENGTH | CFM RATING |
|----------|----------|-----------|---------------|-------------|----------------|--------------|------------|
| 49110U   | 27mm 1"  | 32mm 1¼"  | 108mm 4¼"     | 81mm 3½"    | 150mm 6"       | 33mm 1½"     | 80         |
| 49115U   | 38mm 1½" | 38mm 1½"  | 108mm 4¼"     | 79mm 3½"    | 150mm 6"       | 36mm 1½"     | 165        |
| 49120B   | 51mm 2"  | 51mm 2"   | 143mm 5½"     | 163mm 6½"   | 279mm 11"      | 51mm 2"      | 295        |
| 49125A   | 64mm 2½" | 67mm 2½"  | 143mm 5½"     | 218mm 8½"   | 325mm 12½"     | 51mm 2"      | 450        |
| 49130A   | 76mm 3"  | 80mm 3½"  | 168mm 6½"     | 259mm 10½"  | 378mm 15"      | 64mm 2½"     | 660        |
| 49135A   | 89mm 3½" | 92mm 3½"  | 194mm 7½"     | 305mm 12"   | 447mm 17½"     | 76mm 3"      | 900        |
| 49140A   | 102mm 4" | 105mm 4½" | 216mm 8½"     | 371mm 14½"  | 538mm 21½"     | 86mm 3½"     | 1180       |
| 49150A   | 127mm 5" | 130mm 5½" | 244mm 9½"     | 406mm 16"   | 610mm 24"      | 102mm 4"     | 1840       |
| 49160A   | 152mm 6" | 156mm 6½" | 308mm 12½"    | 559mm 22"   | 686mm 27"      | 51mm 2"      | 2650       |

# TEE BOLT CLAMPS AND AIR INTAKE RUBBERWARE

# TEE BOLT CLAMPS AND AIR INTAKE RUBBERWARE

## Tee Bolt Clamps



Standard – Stainless Steel



Constant Torque – Spring Loaded

## Air Intake – Rubberware – 90° Elbows

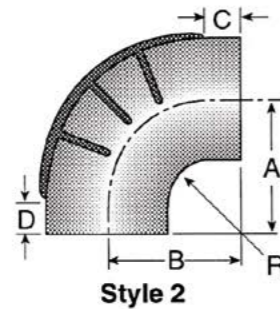
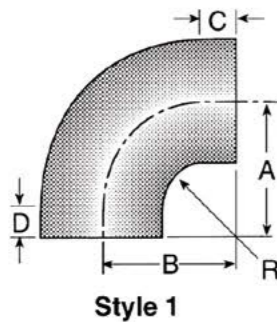

## Air Intake – Rubberware – 45° Elbows

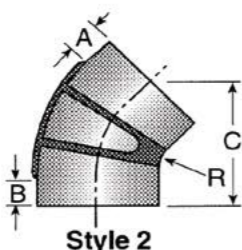
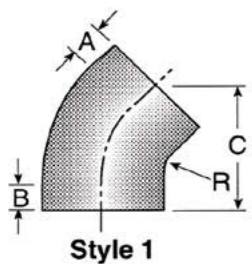

### TEE BOLT CLAMPS

#### STANDARD - STAINLESS STEEL

| SUIT RUBBERWARE ID | ACTUAL CLAMP ID | STANDARD CLAMP PART NUMBER |
|--------------------|-----------------|----------------------------|
| 51mm 2.0"          | 2.25-2.50"      | 3316653S                   |
| 64mm 2.5"          | 2.75-3.06"      | 3316654S                   |
| 76mm 3.0"          | 3.25-3.56"      | 3316656S                   |
| 89mm 3.5"          | 3.75-4.06"      | 3316657S                   |
| 102mm 4.0"         | 4.25-4.56"      | 3316658S                   |
| 114mm 4.5"         | 4.75-5.06"      | 3316659S                   |
| 127mm 5.0"         | 5.25-5.56"      | 3316660S                   |
| 140mm 5.5"         | 5.75-6.06"      | 3316661S                   |
| 152mm 6.0"         | 6.38-6.69"      | 3316662S                   |
| 165mm 6.5"         | -               | 0181165                    |
| 178mm 7.0"         | 7.25-7.76"      | 3316663S                   |
| 203mm 8.0"         | 8.50-8.81"      | 3316664S                   |
| 254mm 10.0"        | 10.50-11.00"    | 3316665S                   |
| 254mm 10.0"        | 10.25-10.75"    | 3316666S                   |

#### CONSTANT TORQUE - SPRING LOADED

| SUIT RUBBERWARE ID | PART NUMBER |
|--------------------|-------------|
| 2.25-2.49"         | TB100SL     |
| 2.69-2.93"         | TB200SL     |
| 3.13-3.37"         | 90588K      |
| 3.63-3.87"         | 90599K      |
| 3.88-4.12"         | TB500SL     |
| 4.13-4.37"         | 90600K      |
| 4.63-4.87"         | 90616K      |
| 5.13-5.37"         | TB800SL     |

\*Use with 45° and 90° Elbows  
\*\* Use with Hump Hose and Reducers

### AIR INTAKE – RUBBERWARE

#### 90° ELBOWS

| ID         | OD           | A     | B     | C     | D     | R     | PART NO  | STYLE |
|------------|--------------|-------|-------|-------|-------|-------|----------|-------|
| 51mm 2"    | 60mm 2.38"   | 4.5"  | 5.5"  | -     | -     | 2"    | 3316564S | 1     |
| 64mm 2.5"  | 73mm 2.88"   | 4.25" | 4.25" | -     | -     | 1.75" | 3316565S | 1     |
| 76mm 3"    | 89mm 3.5"    | 5.25" | 5.25" | 1.75" | 1.5"  | 2"    | 3316566S | 1     |
| 89mm 3.5"  | 102mm 4"     | 5.5"  | 5.5"  | 1.75" | 1.5"  | 2"    | 3316567S | 1     |
| 102mm 4"   | 114mm 4.5"   | 5.75" | 5.75" | 1.75" | 1.5"  | 2"    | 3316568S | 1     |
| 114mm 4.5" | 127mm 5"     | 6"    | 6"    | 1.75" | 1.5"  | 1.75" | 3316569S | 1     |
| 127mm 5"   | 140mm 5.5"   | 6.12" | 6.12" | 1.75" | 1.62" | 1.75" | 3316570S | 2     |
| 140mm 5.5" | 152mm 6"     | 6.5"  | 6.5"  | 1.75" | 1.75" | 1.75" | 3316571S | 2     |
| 140mm 5.5" | 152mm 6"     | 8"    | 5.5"  | 4.5"  | 1.5"  | 1"    | 89829K   | 2     |
| 152mm 6"   | 165mm 6.5"   | 7"    | 7"    | 2.25" | 2"    | 1.75" | 3316573S | 2     |
| 152mm 6"   | 165mm 6.5"   | 5"    | 5"    | 1.5"  | 1.5"  | 1"    | 89830K   | 2     |
| 152mm 6"   | 165mm 6.5"   | 7"    | 9"    | 4.25" | 2"    | 1.75" | 89826K   | 2     |
| 178mm 7"   | 194mm 7.62"  | 7.56" | 7.56" | 2.25" | 2"    | 1.75" | 3316576S | 2     |
| 203mm 8"   | 222mm 8.75"  | 8.5"  | 8.5"  | 2"    | 2.25" | 2.12" | 3316577S | 2     |
| 254mm 10"  | 237mm 10.75" | 10.5" | 10.5" | 2.25" | 2.25" | 3.12" | 3316578S | 2     |

#### 45° ELBOWS

| ID         | OD           | A     | B     | C     | R     | PART NO  | STYLE |
|------------|--------------|-------|-------|-------|-------|----------|-------|
| 76mm 3"    | 89mm 3.5"    | 1.5"  | 1.5"  | 5.5"  | 2"    | 3316579S | 1     |
| 89mm 3.5"  | 102mm 4"     | 4.5"  | 4.5"  | 5.5"  | 2"    | 3316580S | 1     |
| 102mm 4"   | 114mm 4.5"   | 1.5"  | 1.5"  | 5.5"  | 2"    | 3316581S | 1     |
| 114mm 4.5" | 127mm 5"     | 1.5"  | 1.5"  | 5.75" | 1.75" | 3316582S | 1     |
| 127mm 5"   | 140mm 5.5"   | 1.62" | 1.62" | 5.25" | 1.75" | 3316583S | 1     |
| 140mm 5.5" | 152mm 6"     | 1.75" | 1.75" | 6.25" | 1.75" | 3316584S | 1     |
| 152mm 6"   | 165mm 6.5"   | 2"    | 2"    | 6.5"  | 1.75" | 3316585S | 2     |
| 178mm 7"   | 194mm 7.62"  | 2.25" | 2.25" | 8"    | 1.75" | 3316586S | 2     |
| 203mm 8"   | 222mm 8.75"  | 2.25" | 2.25" | 8.25" | 2.12" | 3316587S | 2     |
| 254mm 10"  | 273mm 10.75" | 2.25" | 2.25" | 10.5" | 3.12" | 3316588S | 2     |



## Reducing 90° Elbows

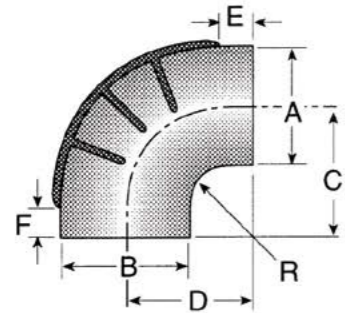

### REDUCING 90° ELBOWS

| A (ID)     | B (ID)   | C     | D     | E     | F     | R     | PART NO  |
|------------|----------|-------|-------|-------|-------|-------|----------|
| 127mm 5"   | 152mm 6" | 7"    | 6"    | 1.5"  | 1.7"  | 1.5"  | 3316589S |
| 140mm 5.5" | 152mm 6" | 6.75" | 6.75" | 1.75" | 1.75" | 1.75" | 3316590S |
| 127mm 5"   | 178mm 7" | 6.75" | 6.75" | 1.75" | 2.75" | 1.5"  | 3316591S |
| 140mm 5.5" | 178mm 7" | 5.75" | 6.25" | 1.5"  | 1.5"  | 0.62" | 3316592S |
| 152mm 6"   | 178mm 7" | 9"    | 7.56" | 3"    | 3"    | 0.5"  | 3316593S |
| 127mm 5"   | 102mm 4" | -     | -     | -     | -     | -     | 89898K   |
| 203mm 8"   | 178mm 7" | 8.5"  | 8.5"  | 2"    | 2"    | 0.5"  | 3940929S |

## Reducing 45° Elbows

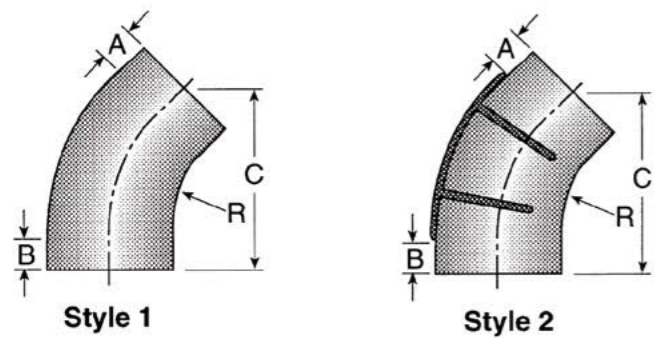

### REDUCING 45° ELBOWS

| ID                             | ID             | A     | B     | C     | R     | PART NO  | STYLE |
|--------------------------------|----------------|-------|-------|-------|-------|----------|-------|
| 152mm x 140mm<br>6.00" x 5.50" | 164mm<br>6.44" | 1.75" | 1.75" | 6.5"  | 4.87" | 3316594S | 1     |
| 178mm x 152mm<br>7.00" x 6.00" | 187mm<br>7.38" | 2"    | 2"    | 7.38" | 5.56" | 3316595S | 2     |

## Special Elbows – Miscellaneous Angles

### SPECIAL ELBOWS – MISCELLANEOUS ANGLES

| DEGREE | ID         | OD          | A     | B     | C     | R     | PART NO  | STYLE |
|--------|------------|-------------|-------|-------|-------|-------|----------|-------|
| 22°    | 102mm 4"   | 114mm 4.5"  | 1.5"  | 1.5"  | 4.5"  | 1.75" | 3316596S | 1     |
| 68°    | 114mm 4.5" | 127mm 5"    | 1.5"  | 1.5"  | 6.75" | 1.75" | 3316597S | 1     |
| 22°    | 140mm 5.5" | 152mm 6"    | 1.75" | 1.75" | 5.25" | 1.75" | 3316598S | 1     |
| 54°    | 140mm 5.5" | 152mm 6"    | 1.75" | 1.75" | 7.75" | 2.5"  | 3316599S | 1     |
| 68°    | 140mm 5.5" | 152mm 6"    | 1.75" | 1.75" | 8.25" | 4"    | 3316600S | 1     |
| 22°    | 152mm 6"   | 165mm 6.5"  | 1.75" | 1.75" | 5.25" | 1.75" | 3316601S | 1     |
| 38°    | 152mm 6"   | 165mm 6.5"  | 2.3"  | 2.3"  | 7.25" | 0.72" | 3316602S | 1     |
| 54°    | 152mm 6"   | 165mm 6.5"  | 1.5"  | 1.5"  | 7.5"  | 2.5"  | 3316603S | 2     |
| 68°    | 152mm 6"   | 165mm 6.5"  | 1.75" | 1.75" | 8.5"  | 4"    | 3316604S | 2     |
| 63°    | 203mm 8"   | 222mm 8.75" | 2"    | 2"    | 11"   | 1.25" | 3316605S | 2     |

### AIR INLET COMPONENTS

#### Air Rams

The Air Ram replaces conventional air stack caps, resulting in reduced restriction, no carbon recirculation, longer element life and moisture elimination.

| PART NO   | SUIT PIPE OD            |
|-----------|-------------------------|
| AR076     | 76mm 3"                 |
| AR102     | 102mm 4"                |
| AR127     | 127mm 5"                |
| AR152     | 152mm 6"                |
| AR152/178 | 152/178mm (low profile) |
| AR178     | 178mm 7"                |

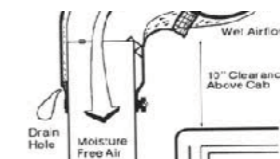

- Lightweight
- Corrosion Resistant

## Hump Hose

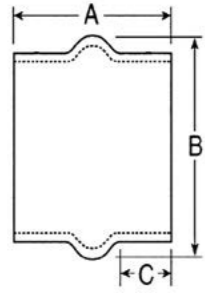

| HUMP HOSE    |       |       |       |          |  |
|--------------|-------|-------|-------|----------|--|
| ID x ID      | A     | B     | C     | PART NO  |  |
| 76mm 3.00"   | 5.25" | 4.5"  | 2"    | 3316606S |  |
| 89mm 3.50"   | 5.25" | 5"    | 2"    | 3316607S |  |
| 102mm 4.00"  | 5.25" | 5.37" | 2"    | 3316608S |  |
| 114mm 4.50"  | 5.25" | 5.87" | 1.75" | 3316609S |  |
| 127mm 5.00"  | 6"    | 6.12" | 2.25" | 3316610S |  |
| 140mm 5.50"  | 6"    | 7"    | 2.25" | 3316611S |  |
| 152mm 6.00"  | 7"    | 7.5"  | 2.75" | 3316612S |  |
| 178mm 7.00"  | 7"    | 8.5"  | 2.5"  | 3316613S |  |
| 203mm 8.00"  | 5"    | 9.5"  | 1.5"  | 3316614S |  |
| 254mm 10.00" | 6"    | 11.5" | 2"    | 3316615S |  |

## Hump Hose Reducers

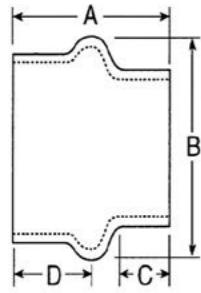

| HUMP HOSE REDUCERS |               |       |       |       |         |          |
|--------------------|---------------|-------|-------|-------|---------|----------|
| ID x ID            | A             | B     | C     | D     | PART NO |          |
| 76mm x 64mm        | 3.00 x 2.50"  | 6"    | 4.25" | 2.12" | 3"      | 900012K  |
| 89mm x 76mm        | 3.50 x 3.00"  | 5.25" | 5"    | 2.12" | 2.12"   | 3316616S |
| 102mm x 76mm       | 4.00 x 3.00"  | 5.25" | 5.5"  | 1.5"  | 1.75"   | 3316617S |
| 102mm x 89mm       | 4.00 x 3.50"  | 5"    | 5.25" | 2"    | 2.5"    | Q710300  |
| 127mm x 102mm      | 5.00 x 4.00"  | 5.5"  | 6.5"  | 1.5"  | 1.75"   | 3316618S |
| 140mm x 102mm      | 5.50 x 4.00"  | 6"    | 7"    | 1.87" | 2"      | 3316619S |
| 140mm x 127mm      | 5.50 x 5.00"  | 6"    | 7"    | 1.87" | 2"      | 3316620S |
| 152mm x 127mm      | 6.00 x 5.00"  | 6"    | 7.5"  | 1.87" | 2"      | 3316621S |
| 152mm x 140mm      | 6.00 x 5.50"  | 6"    | 7.5"  | 2"    | 2"      | 3316622S |
| 178mm x 140mm      | 7.00 x 5.50"  | 7"    | 8.5"  | 2.25" | 2.75"   | 3316623S |
| 178mm x 152mm      | 7.00 x 6.00"  | 5"    | 8.5"  | 1.44" | 1.5"    | 3316624S |
| 203mm x 140mm      | 8.00 x 5.50"  | 7"    | 9.5"  | 1.75" | 1.75"   | 3316625S |
| 203mm x 152mm      | 8.00 x 6.00"  | 5"    | 9.5"  | 1.38" | 1.5"    | 3316626S |
| 203mm x 178mm      | 8.00 x 7.00"  | 5"    | 9.5"  | 1.44" | 1.5"    | 3316627S |
| 254mm x 203mm      | 10.00 x 8.00" | 6"    | 11.5" | 1.75" | 2"      | 3316628S |



# ABBREVIATIONS

|                     |  |
|---------------------|--|
| <b>US &amp; USA</b> | United States & United States of America |
| <b>AUS</b>          | Australia                                |
| <b>OD</b>           | Outer Diameter                           |
| <b>dBA</b>          | Decibel Rating                           |
| <b>CLR</b>          | Centre Line Radius                       |
| <b>ID</b>           | Inner Diameter                           |
| <b>O/A</b>          | Overall                                  |
| <b>EPA</b>          | Environment Protection Authority         |
| <b>OEM</b>          | Original Equipment Manufacturer          |
| <b>OE</b>           | Original Equipment                       |
| <b>Hg</b>           | Mercury                                  |
| <b>CFM</b>          | Cubic Feet per Minute                    |
| <b>PSI</b>          | Pounds per Square Inch                   |
| <b>kW</b>           | Kilowatts                                |
| <b>HP</b>           | Horse Power                              |
| <b>MM</b>           | Millimetre                               |
| <b>MTR</b>          | Metres                                   |
| <b>GVM</b>          | Gross Vehicle Mass                       |
| <b>EXP</b>          | Expand                                   |

# CUSTOMER SUPPORT EVERY PLACE YOU NEED IT

The Cummins name is about commitment, not compromise, which is why we provide industry-leading service support to our customers.

Our extensive support network in the South Pacific region includes 36 branches, more than 650 technicians and 275 field service vehicles, and the award-winning Cummins Support Centre in Melbourne which can be contacted via hotline 24 hours a day, every day of the year for after-hours assistance and technical advice and support.

## Everywhere. Cummins locations.

### AUSTRALIA

#### Australian Capital Territory

Canberra 02 6297 3433

#### New South Wales

Grafton 02 6641 1000

Leeton 02 6953 3077

Muswellbrook 02 6541 0611

Newcastle 02 4964 8466

Tamworth 02 6765 5455

Wetherill Park 02 9616 5300

#### Northern Territory

Alice Springs 0407 340 779

Darwin 08 8935 2200

#### Queensland

Brisbane 07 3710 4700

Cairns 07 4040 9100

Emerald 07 4983 9000

Mackay 07 4952 8100

Mt Isa 07 4749 8600

Toowoomba 07 4633 7627

Townsville 07 4774 7733

#### South Australia

Adelaide 08 8368 4300

Mount Gambier 08 8725 6422

Port Lincoln 08 8683 1967

#### Tasmania

Devonport 03 6424 8800

#### Victoria

Campbellfield 03 9357 9200

Laverton 03 8368 0800

Mildura 03 5025 9900

Pakenham 03 5943 3700

Swan Hill 03 5033 1511

Wodonga 02 6024 3655

#### Western Australia

Bunbury 08 9725 6777

Geraldton 08 9964 5449

Kalgoorlie 08 9080 1300

Karratha 08 9144 4646

Perth 08 9475 8777

Port Hedland 08 9174 3200

### NEW ZEALAND

Auckland 09 277 1000

Bay Of Plenty 07 345 6699

Palmerston Nth 06 356 2209

### PAPUA NEW GUINEA

Lae 05 475 7000

Port Moresby 05 323 2471

Further proof of our commitment is a strategic network of 140 authorised dealers.

Parts availability is another key element of our support capability. Our central parts distribution centre in Melbourne has over 50,000 lines of inventory and ships parts daily to our vast branch and dealer network.



For Australia

**1300Cummins**  
Ph 1300 286 646

For New Zealand

**0800Cummins**  
Ph 0800 286 646



Cummins Head Office  
2 Caribbean Drive  
Scoresby Vic 3179 Australia  
Phone 613 9765 3222  
Fax 613 9763 0079  
[www.cummins.com.au](http://www.cummins.com.au)